

LOCATION MAP

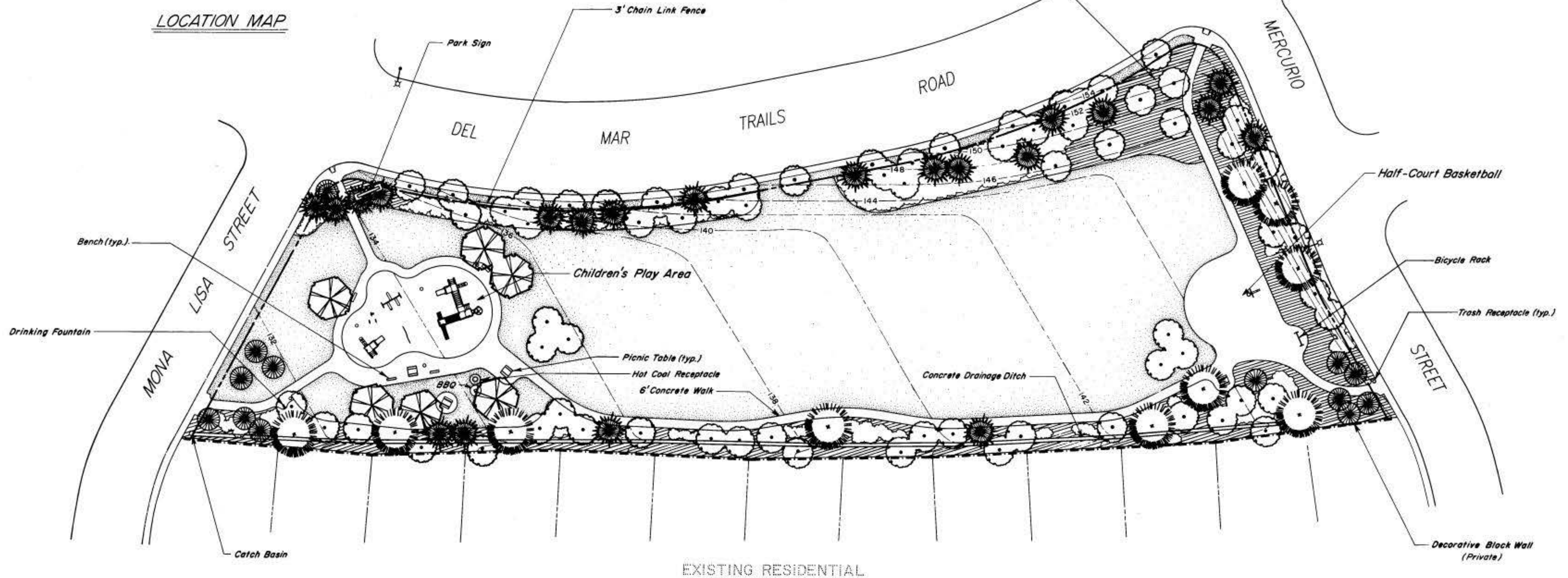
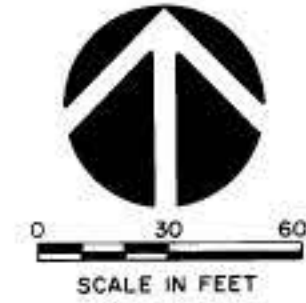

EXISTING RESIDENTIAL

DATA LOG FOR			
DATE	ACTION	REFERENCE DOCUMENTS	
	SITE ACQUIRED	RESO NO	COST \$
	SITE DEDICATED	ORD NO	ACRES
	GDP CONSULTANT HIRED	RESO NO	NAME AUSTIN-HANSEN GROUP
6-90	P & R BOARD APPROVAL	PF & R APPROVAL	
4-1-93	INITIAL DEVELOPMENT	CIP NO 29-713	JO NO 119403
		CIP NO	DRWG NO 25975-D
		CIP NO	DRWG NO
		CIP NO	DRWG NO
		CIP NO	DRWG NO
		CIP NO	DRWG NO
		CIP NO	DRWG NO

IMPROVEMENTS SUMMARY (DATA FROM AS-BUILT DRAWINGS)			
ITEM	QUANTITY	ITEM	QUANTITY
TOTAL SITE	2.99 AC	PLAY AREA	4,896 SF
IMPROVED AREA	3.23 AC	MULTI PURPOSE CT	SF
TURF	1.84 AC	TENNIS CTS	SF
GROUND COVER	.90 AC	RESTROOM	SF
NATURAL	AC	REC BLDG	SF
OTHER LANDSCAPING	AC	POOL BLDG	SF
DIRT INFIELDS	AC	" " DECK	SF
PARK SIGN	1 EA	" " WATER	SF
TRASH RECEPTACLES	5 EA	HOT COAL RECEPTACLES	1 EA
		DRINKING FOUNTAINS	1 EA
		REVISION	T.R. 10-17-94

CITY OF SAN DIEGO PARK and RECREATION DEPARTMENT

THE GENERAL DEVELOPMENT PLAN

DEL MAR TRAILS

RENAISSANCE PARK

COUNCIL DIST. NO. 1 COMM. PLAN AREA NORTH CITY WEST - 24

LAMBERT COORDINATES 282-1703 THOMAS BROS PG. 1188, C-7

PSD NO 190