

**PASSIVE PLAY AREA**

- 3+ ACRES OPEN PLAY
- TURF - GN-1 HYBRID BERMUDA, OVER SEED WITH TURF STAR RYE @ 5LBS/1000SF

**FITNESS STATIONS**

- 14 STATIONS
- TREE LINED BACKDROP
- VIEWS TO OTAY VALLEY REGIONAL PARK
- 3' FENCE
- ADA ACCESSIBLE

**DROUGHT TOLERANT LANDSCAPED SEATING AREAS, TYP.**

- DROUGHT TOLERANT PLANTINGS
- EARTH MOUNDS/ BOULDERS
- DG PATHWAYS
- PICNIC TABLES/ BENCHES

**DRINKING FOUNTAIN**

**PICNIC SHELTER AREA - EAST**

- PREFABRICATED SHELTER
- PICNIC TABLES
- BBQ AREA
- TABLE SEATING
- DRINKING FOUNTAIN

**MINI STAGE**

- CONCRETE STAGE FOR POTENTIAL OUTDOOR EXERCISE CLASSES

**ACTIVE USE TOT LOT**

- 2-5 AGES
- 5-12 AGES
- SHADE SAILS
- RUBBER PLAY SURFACE / ADA ACCESSIBLE
- 3' LOW PERIMETER FENCE

**LEGEND**

- DRINKING FOUNTAIN
- DOG DRINKING FOUNTAIN
- DOG WASTE STATION
- SECURITY LIGHTING
- CONCRETE TRASH CANS WITH RECYCLING CANS MATCHED WITH EACH
- BBQ
- HOT COAL RECEPTACLE
- BIKE RACK
- TRAIL SIGNAGE
- BENCH
- PARK TABLE
- PICNIC TABLE
- SHELTER
- RESTROOMS
- METAL PICKET FENCE 3' OR 5'
- 2 RAIL FENCE
- TURF GRASS
- DROUGHT TOLERANT PLANTING
- DECOMPOSED GRANITE
- WALKWAYS

**RESTROOMS**

- 1 ALL GENDER STALL
- 2 ALL GENDER ADA STALL
- LAVATORY EACH
- POTENTIAL MAINTENANCE RM.

**PUBLIC FENCE**

- 5' BLACK TUBULAR STEEL FENCE

**PARK ENTRY**

- 4' OPENING IN 5' TALL BLACK TUBULAR STEEL FENCE

**TREE GROVE**

- NATURAL URBAN FOREST BUFFER
- CHILDREN EXPLORATION & DISCOVERY
- TRAIL

**EARTHMOUND**

- BUFFER TO TOT LOT & PICNIC AREA

**DRINKING FOUNTAIN**

**NATURE THEME TOT LOT**

- NATURE THEME PLAY EQUIPMENT
- WOOD BARK PLAY SURFACE

**PICNIC SHELTER AREA - WEST**

- SHADE STRUCTURE
- 4 PICNIC TABLES
- BBQ
- TRASH CAN
- HOT COAL RECEPTACLE
- DRINKING FOUNTAIN

**PARK ENTRY**

- 4' OPENING IN 5' TALL BLACK TUBULAR STEEL FENCE

**VIEWING RETREAT**

- LARGE SHADE TREE
- LOW SEAT WALL PLANTER

**LAWN MOUNDS**

- 30" TALL
- PASSIVE VIEWING
- SHADY GROVE

**BICYCLE PLAYGROUND**

- OUTER RING - BICYCLE AGILITY COURSE ON CONCRETE TRAIL
- INNER RING - CONCRETE PUMP TRACK
- DROUGHT TOLERANT PLANTING ON PERIMETER

**TRAIL HEAD TO OVRP**

- STAGING AREA
- TRAIL INFORMATION SIGNAGE
- BIKE RACK

**DROUGHT TOLERANT PLANTING**

**DOG PARK**

- SMALL AND LARGE DOG RUNS
- BENCHES
- BLACK VINYL COATED CHAIN LINK FENCE
- DOG WATER FOUNTAINS
- PET WASTE BAG DISPENSERS
- DECOMPOSED GRANITE - TAN COLOR

**BASKETBALL**

- (2) 1/2 COURTS
- CHAIN LINK SEPARATION FENCE FROM PARKING LOT

**SKATE PARK**

- PRE-FAB CONCRETE
- SKATE RAMPS
- GRINDING RAIL

**CURRENT SIGNAL TO BE CONVERTED TO 4 WAY SIGNALLED INTERSECTION**

**ENTRY PLAZA**

- ZERO CURB DROP OFF WITH BOLLARDS
- ADA ACCESSIBLE DROP OFF
- PARK SIGNAGE
- SHADE GROVE
- BENCHES

**PARKING LOT**

- 75 STALLS
- ENHANCED STRIPING AT PEDESTRIAN CROSSINGS

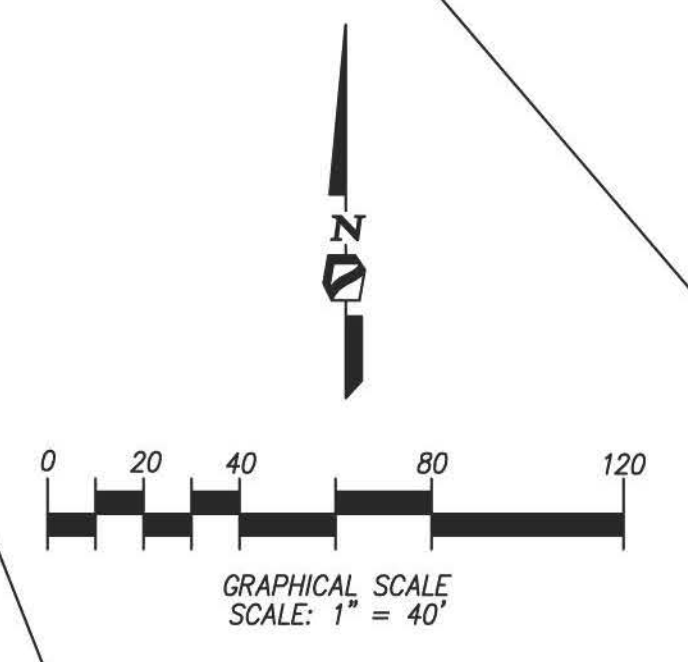

COUNCIL DISTRICT: 8 COMMUNITY PLAN AREA: OTAY MESA COMMUNITY PLAN

DATE	ACTION	REFERENCE DOCUMENTS
	SITE ACQUIRED	RESO. NO. R- COST \$:
	SITE DEDICATED	ORD. NO. ACRES:
	GDP CONSULTANT HIRED	RESO. NO. NAME: PROJECT DESIGN CONSULTANTS
	P&R BOARD APPROVAL	PF&R APPROVAL DATE:
	INITIAL DEVELOPMENT	
	CIP NO.	J.O. NO. DRWG. NO.
	CIP NO.	J.O. NO. DRWG. NO.
	CIP NO.	J.O. NO. DRWG. NO.
	CIP NO.	J.O. NO. DRWG. NO.
	CIP NO.	J.O. NO. DRWG. NO.
	CIP NO.	J.O. NO. DRWG. NO.
	CIP NO.	J.O. NO. DRWG. NO.

**IMPROVEMENTS SUMMARY (DATA FROM AS-BUILT DRAWINGS)**

ITEM	QUANTITY	ITEM	QUANTITY	ITEM	QUANTITY	ITEM	QUANTITY
TOTAL SITE	9.00 AC.	TOT LOT	2,772 SF	WALKWAYS	58,883 SF	SECURITY LTS.	40 STDS.
IMPROVED AREA	9.00 AC.	ACTIVE SPORT CT.	18,671 SF	PARK ROADS	9,351 SF	BENCHES	20 EA.
TURF	3.85 AC.	LAWN EDGING	3,204 LF	PARKING LOT	21,275 SF	PICNIC TABLES	20 EA.
ORNAMENTAL PLANTING	1.58 AC.	DG EDGING	703 LF	PARKING STALLS-STD.	73	FOOD COURT TABLES	12 EA.
NATURAL PLANTING	.68 AC.			PARKING STALLS-DISABLED	2	DOG DRINKING FOUNTAINS	2 EA.
D.G. PAVING	0.31 AC.					DRINKING FOUNTAINS	2 EA.
DOG PARK DG	.50 AC.					BIKE RACKS	2 EA.
RESTROOM	1					TRASH RECEPTACLES	8 EA.

CITY OF SAN DIEGO PARK AND RECREATION DEPARTMENT

THE GENERAL DEVELOPMENT PLAN

# DENNERLY RANCH

NEIGHBORHOOD PARK

PSD (PSD #)

LAMBERT COORDINATES: THOMAS BROTHERS PAGE: 1330 H-6