

ROUTE 163

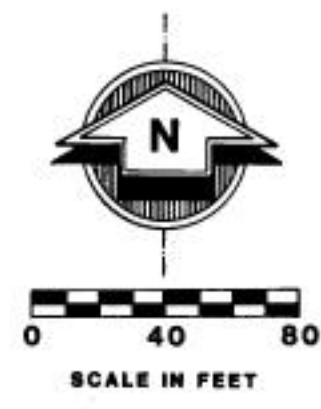
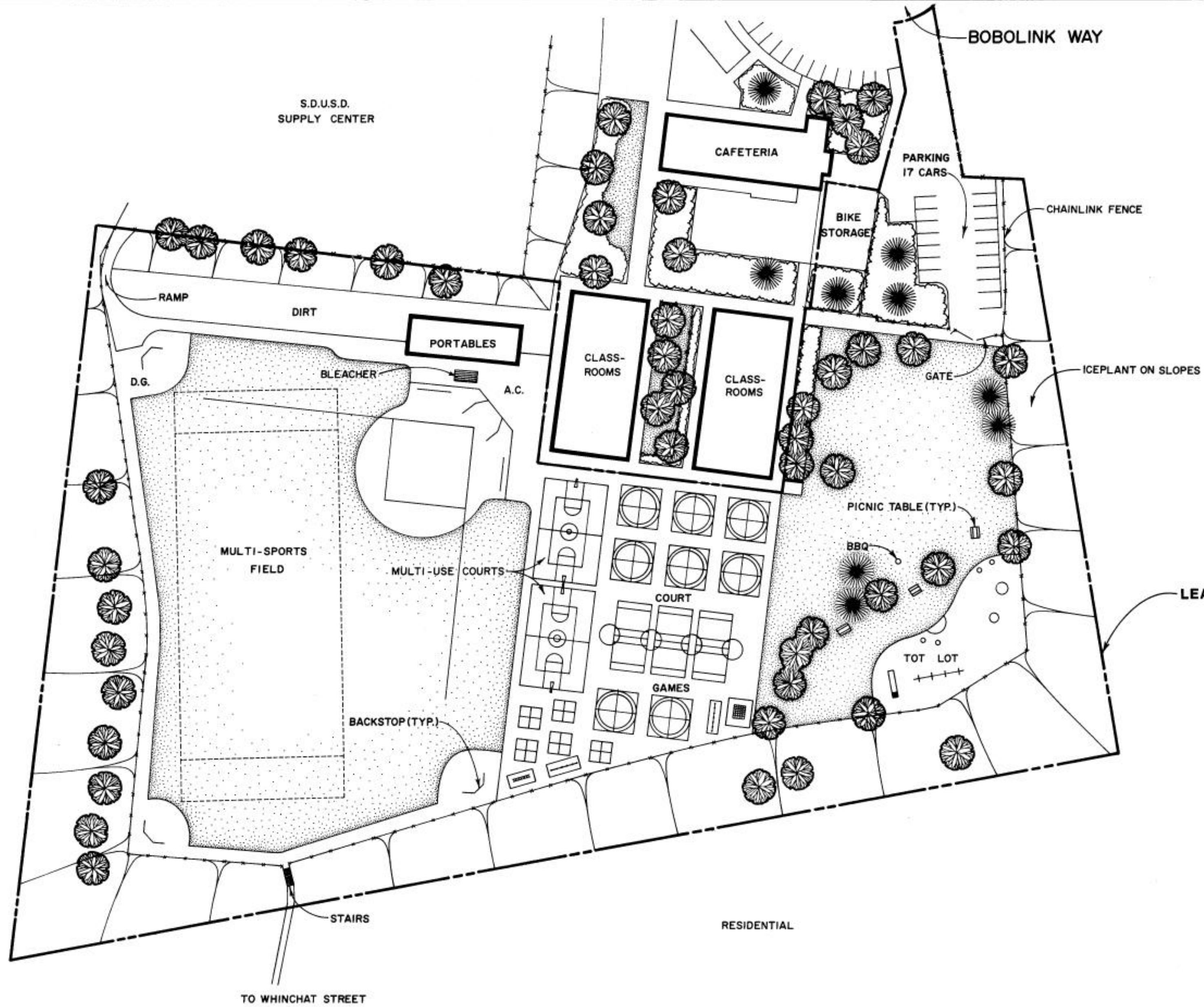

DATA LOG FOR:

DATE	ACTION	REFERENCE DOCUMENTS	COST #	ACRES:
12-78	SITE ACQUIRED	RESO NO O-12531		7.40
	SITE DEDICATED	ORD. NO.		ACRES:
	GDP CONSULTANT HIRED	RESO NO.	NAME STAFF/SCHOOL	
	P. & R. BOARD APPROVAL	PF & R. APPROVAL		
6-10-79	INITIAL DEVELOPMENT	CIP NO.	JO NO. 117658	DRWG NO. 18138-D
		CIP NO.	JO NO.	DRWG NO.
		CIP NO.	JO NO.	DRWG NO.
		CIP NO.	JO NO.	DRWG NO.
		CIP NO.	JO NO.	DRWG NO.
		CIP NO.	JO NO.	DRWG NO.

IMPROVEMENTS SUMMARY (DATA FROM AS-BUILT DRAWINGS)

ITEM	QUANTITY	ITEM	QUANTITY	ITEM	QUANTITY
TOTAL SITE	7.40 AC	PLAY AREA	7,520 SF	PAVED WALKS	1,490 SF
IMPROVED AREA	6.23 AC	MULTI PURPOSE CT	SF	PARK ROADS	3,632 SF
TURF	2.68 AC	TENNIS CTS	SF	PARKING LOT	6,640 SF
SHRUB BED	.10 AC	RESTROOM	SF	" " STALLS STD	MULTI PURPOSE CT.
NATURAL	AC	REC. BLDG	SF	" " STALLS HDCP	
OTHER LANDSCAPING	1.17 AC	POOL BLDG	SF	COURT GAME AREA	37,756 SF
DIRT INFIELDS	.23 AC	" " DECK	SF	BACKSTOPS	4 EA
D.G.	.24	" " WATER	SF	TENNIS CTS	EA
				LAWN EDGING	LF
				REVISION	TR 4-5-93

CITY OF SAN DIEGO PARK and RECREATION DEPARTMENT

THE GENERAL DEVELOPMENT PLAN

FLETCHER

ELEMENTARY SCHOOL/PARK (BIRDLAND PARK)

COUNCIL DIST. NO. 6 COMM. PLAN AREA SERRA MESA - 38 7666 BOBOLINK WAY P.S.D. NO. 402
 LAMBERT COORDINATES 226-1731 THOMAS BROS. PG.53, C-5