

GENERAL DEVELOPMENT PLAN FOR: HICKMAN FIELD COMMUNITY PARK

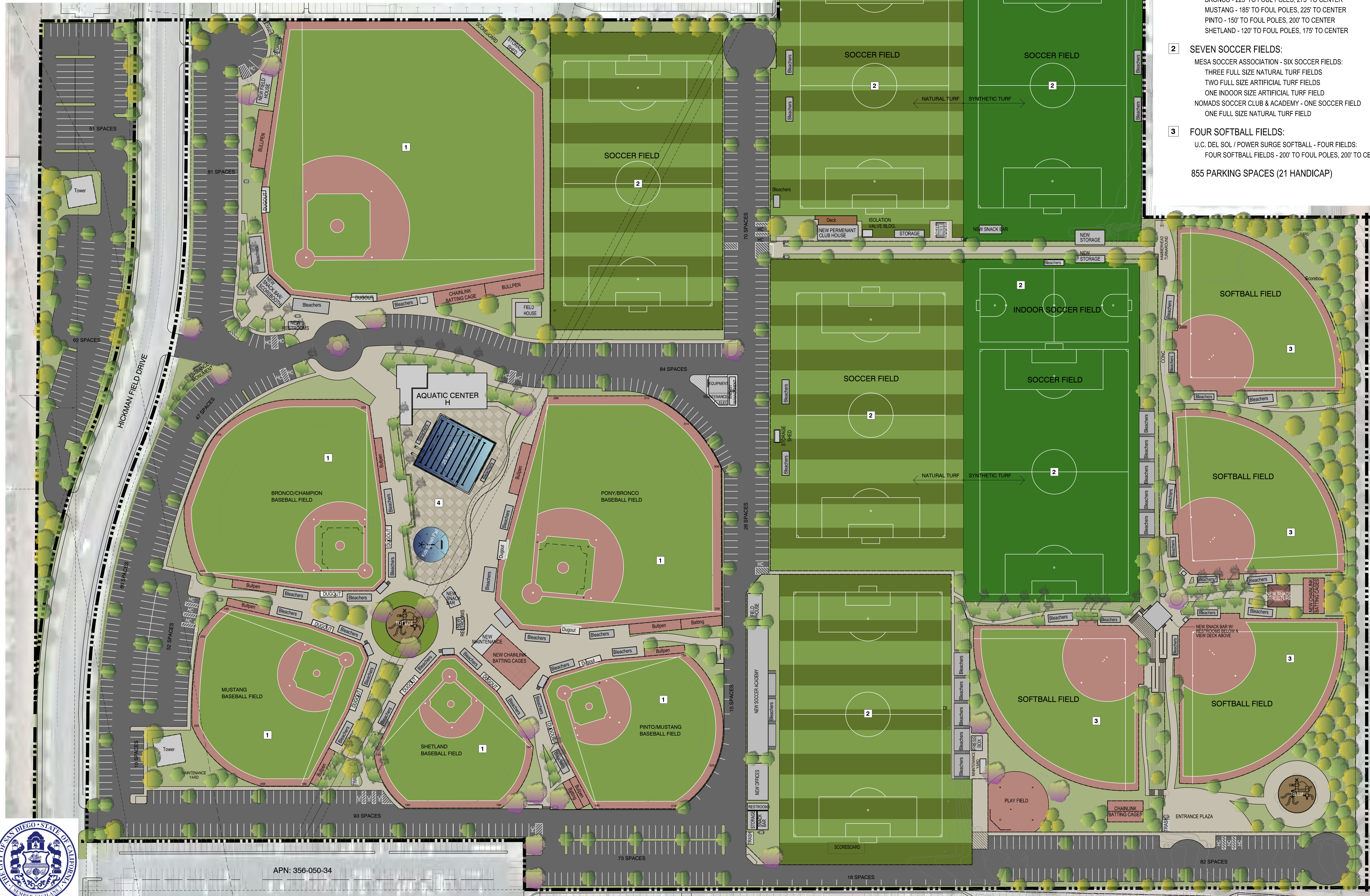

PROJECT SUMMARY

- 1 SIX BASEBALL FIELDS:**
ST. AUGUSTINE H.S. / CLAIREMONT COLT - ONE BASEBALL FIELD.
322' TO FOUL POLES, 385' TO CENTER
N.C.Y.B. - FIVE BASEBALL FIELDS OF VARIOUS DIMENSIONS:
PONY - 260' TO FOUL POLES, 315' TO CENTER
BRONCO - 225' TO FOUL POLES, 275' TO CENTER
MUSTANG - 185' TO FOUL POLES, 225' TO CENTER
PINTO - 150' TO FOUL POLES, 200' TO CENTER
SHETLAND - 120' TO FOUL POLES, 175' TO CENTER
- 2 SEVEN SOCCER FIELDS:**
MESA SOCCER ASSOCIATION - SIX SOCCER FIELDS:
THREE FULL SIZE NATURAL TURF FIELDS
TWO FULL SIZE ARTIFICIAL TURF FIELDS
ONE INDOOR SIZE ARTIFICIAL TURF FIELD
NOMADS SOCCER CLUB & ACADEMY - ONE SOCCER FIELD
ONE FULL SIZE NATURAL TURF FIELD
- 3 FOUR SOFTBALL FIELDS:**
U.C. DEL SOL / POWER SURGE SOFTBALL - FOUR FIELDS:
FOUR SOFTBALL FIELDS - 200' TO FOUL POLES, 200' TO CENTER

855 PARKING SPACES (21 HANDICAP)
- 4 AQUATIC COMPLEX:**
75' (10 LANE) POOL
CHILDREN'S SPLASH PAD
AQUATIC BUILDING
EQUIPMENT/STORAGE
LOCKER ROOMS
OFFICES
MULTI-PURPOSE COMMUNITY ROOMS (2)
LOBBY
TRAINING FACILITIES

LEGEND

- PROPERTY LINE
- NATURAL TURF
- SYNTHETIC TURF
- DIRT INFIELD
- HARDSCAPE
- BUILDING/STRUCTURE

VICINITY MAP

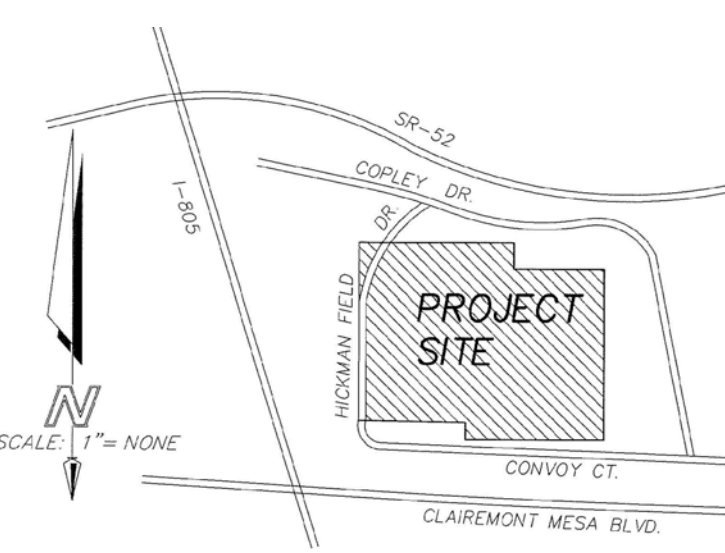

PREPARED BY:

mlaSD
Dr. Dullough Landscape Architecture, Inc.
363 5th Avenue, Suite 301
San Diego, California 92101
tel (619) 296-3150 fax (619) 501-7725
www.mlasd.com

LINDMARK
CONSULTING
Planning Engineering Surveying
8585 Genesee Avenue, Suite 200
San Diego, CA 92121 (619) 597-8070

PREPARED FOR:



APN: 356-050-34

