

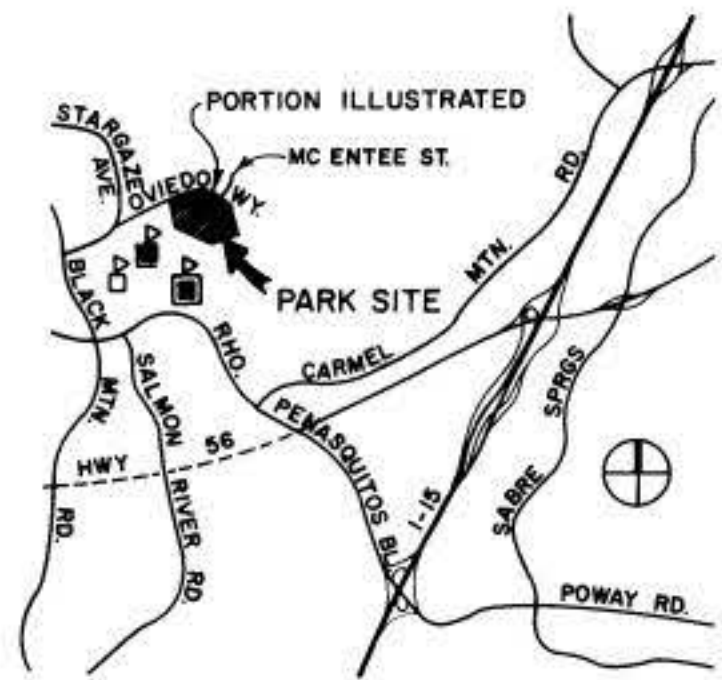

0' 50' 100'

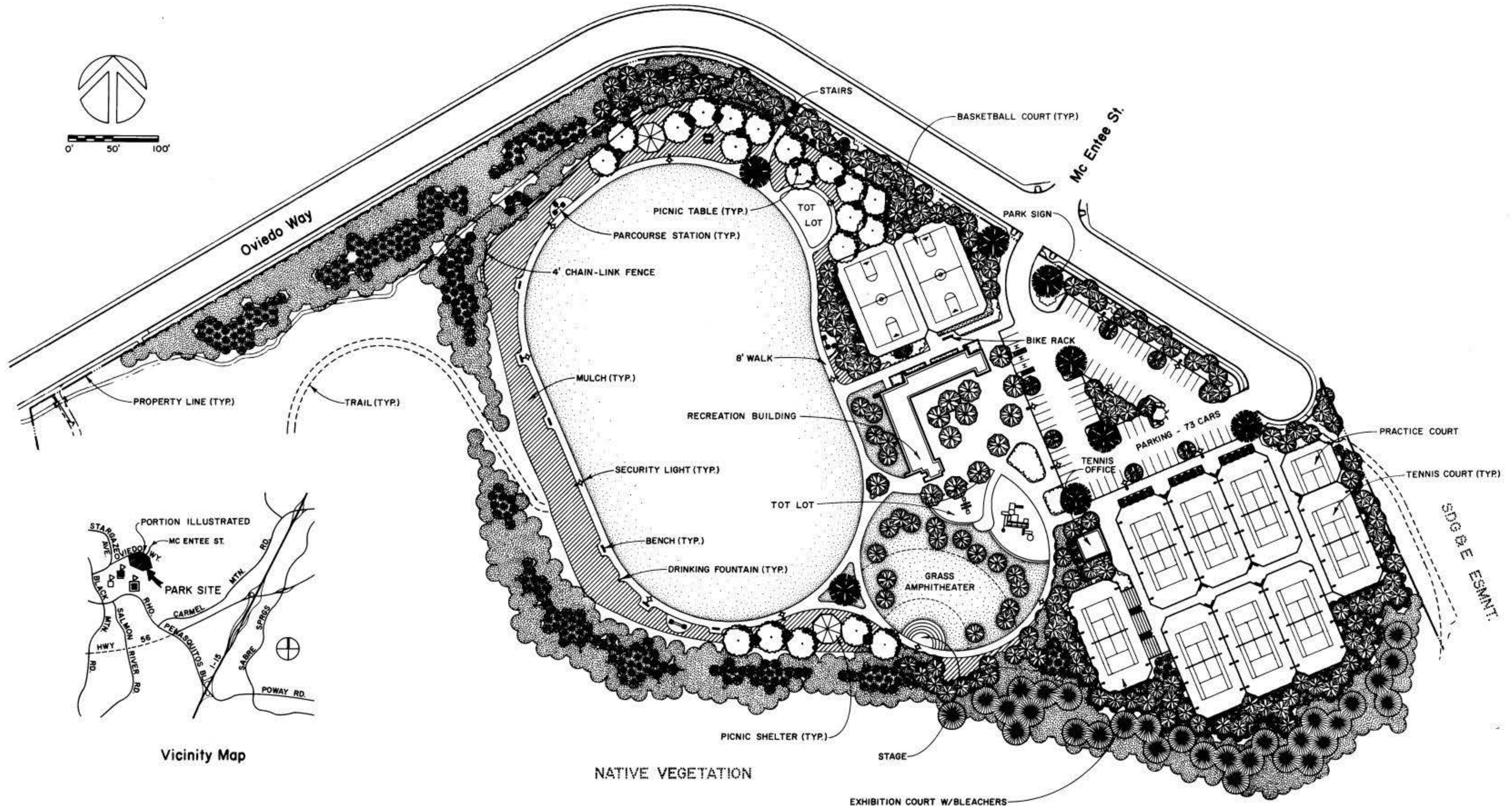

Vicinity Map

NATIVE VEGETATION

DATA LOG FOR:			
DATE	ACTION	REFERENCE DOCUMENTS	
11/30/79	SITE ACQUIRED	RESO. NO. 250258 COST \$ 298,800 ACRES: 33.20	
11/13/79	SITE DEDICATED	ORD. NO. 15072 ACRES: 33.20	
3/21/90	G.O.P. CONSULTANT HIRED	RESO. NO. C-03149 NAME W.E. PEACH & ASSOC.	
1/16/92	P.&R. BOARD APPROVAL	P.F. & R. APPROVAL	
	INITIAL DEVELOPMENT	CIP NO. JO NO. DRWG. NO.	
		CIP NO. JO NO. DRWG. NO.	
		CIP NO. JO NO. DRWG. NO.	
		CIP NO. JO NO. DRWG. NO.	
		CIP NO. JO NO. DRWG. NO.	
		CIP NO. JO NO. DRWG. NO.	

IMPROVEMENTS SUMMARY (ESTIMATES)			
ITEM	QUANTITY	ITEM	QUANTITY
TOTAL SITE	33.20 AC	PLAY AREA	7,282 SF
IMPROVED AREA	13.52 AC	MULTI PURPOSE CT	15,904 SF
TURF	3.90 AC	TENNIS CTS	58,800 SF
SHRUB BED	4.60 AC	TENNIS OFFICE	1,024 SF
NATURAL	20.04 AC	REC. BLDG.	5,328 SF
MULCH	1.12 AC	STAGE	450 SF
BIKE RACK	1 EA.	" " DECK	SF
BENCHES	6 EA.	" " WATER	SF
PICNIC SHELTERS	2 EA.	DRINKING FOUNTAINS	2 EA.
		EXERCISE STATIONS	3 EA.
		REVISION	T.R. 2/5/93

CITY OF SAN DIEGO PARK and RECREATION DEPARTMENT

THE GENERAL DEVELOPMENT PLAN

HILLTOP COMMUNITY PARK

COUNCIL DIST. NO. 1 COMM. PLAN AREA PENASQUITOS EAST-33

LAMBERT COORDINATES 292-1731 THOMAS BROS PG. 36, A-2&3

PSD NO. 140