

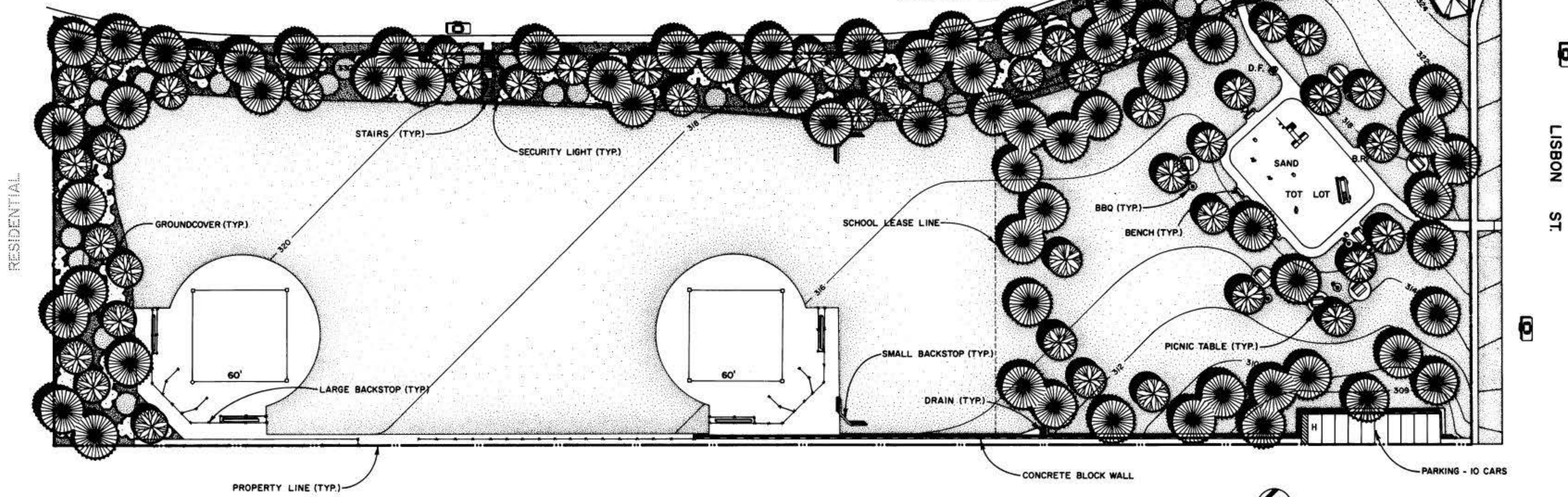

VICINITY MAP

WOODROW AVE.



RESIDENTIAL

LISBON ST.

KEILLER MIDDLE SCHOOL

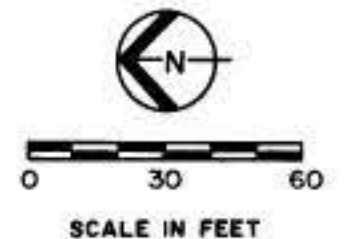

DATA LOG FOR:				
DATE	ACTION	REFERENCE DOCUMENTS		
5/12/76	SITE ACQUIRED	RESO NO R215948	COST \$ 90,000	ACRES 5.77
10/6/78	SITE DEDICATED	ORD NO 12455		ACRES 5.77
7/18/88	GDP CONSULTANT HIRED	RESO NO C02530	NAME DE WEESE BURTON INC./STAFF	
2/16/89	P.E.R. BOARD APPROVAL	PF & R APPROVAL		
6/26/92	TOTAL DEVELOPMENT	CIP NO 29-257	JO NO 118913	DRWG NO 25064-D
		CIP NO	JO NO	DRWG NO
		CIP NO	JO NO	DRWG NO
		CIP NO	JO NO	DRWG NO
		CIP NO	JO NO	DRWG NO
		CIP NO	JO NO	DRWG NO

IMPROVEMENTS SUMMARY (DATA FROM AS-BUILT DRAWINGS)							
ITEM	QUANTITY	ITEM	QUANTITY	ITEM	QUANTITY	ITEM	QUANTITY
TOTAL SITE	5.77 AC	PLAY AREA	4,878 SF	PAVED WALKS	15,887 SF	SECURITY LTS	4 STDS
IMPROVED AREA	6.15 AC	MULTI PURPOSE CT	SF	PARK ROADS	SF	BALL FIELD LTS	STDS
TURF	4.06 AC	TENNIS CTS	SF	PARKING LOT	1,680 SF	TENNIS CT LTS	STDS
SHRUB BED	1.16 AC	RESTROOM	SF	" STALLS STD	9	MULTI PURPOSE CT	STDS
NATURAL	AC	REC BLDG	SF	" STALLS HDCP	1		
OTHER LANDSCAPING	AC	POOL BLDG	SF	COURT GAME AREA	SF	BACKSTOPS	4 EA
DIRT INFIELDS	.42 AC	" DECK	SF			TENNIS CTS	EA
DRINKING FOUNTAIN	1 EA	" WATER	SF	LAWN EDGING	3,543 LF	BBQ	5 EA
BIKE RACK	1 EA	PICNIC TABLES	7 EA	BENCHES	3 EA	TRASH RECEPTACLES	2 EA
PARK SIGN	1 EA	AREA LEASED TO SCHOOL	3.0 AC				
				REVISION	T.R. 4/19/94		

CITY OF SAN DIEGO PARK and RECREATION DEPARTMENT

THE GENERAL DEVELOPMENT PLAN

# KEILLER

## NEIGHBORHOOD PARK

COUNCIL DIST. NO. 4 COMM PLAN AREA SKYLINE - PARADISE HILLS 39  
 LAMBERT COORDINATES 198-1755 THOMAS BROS PG. 67, B-1 & 2

PSD NO 692