

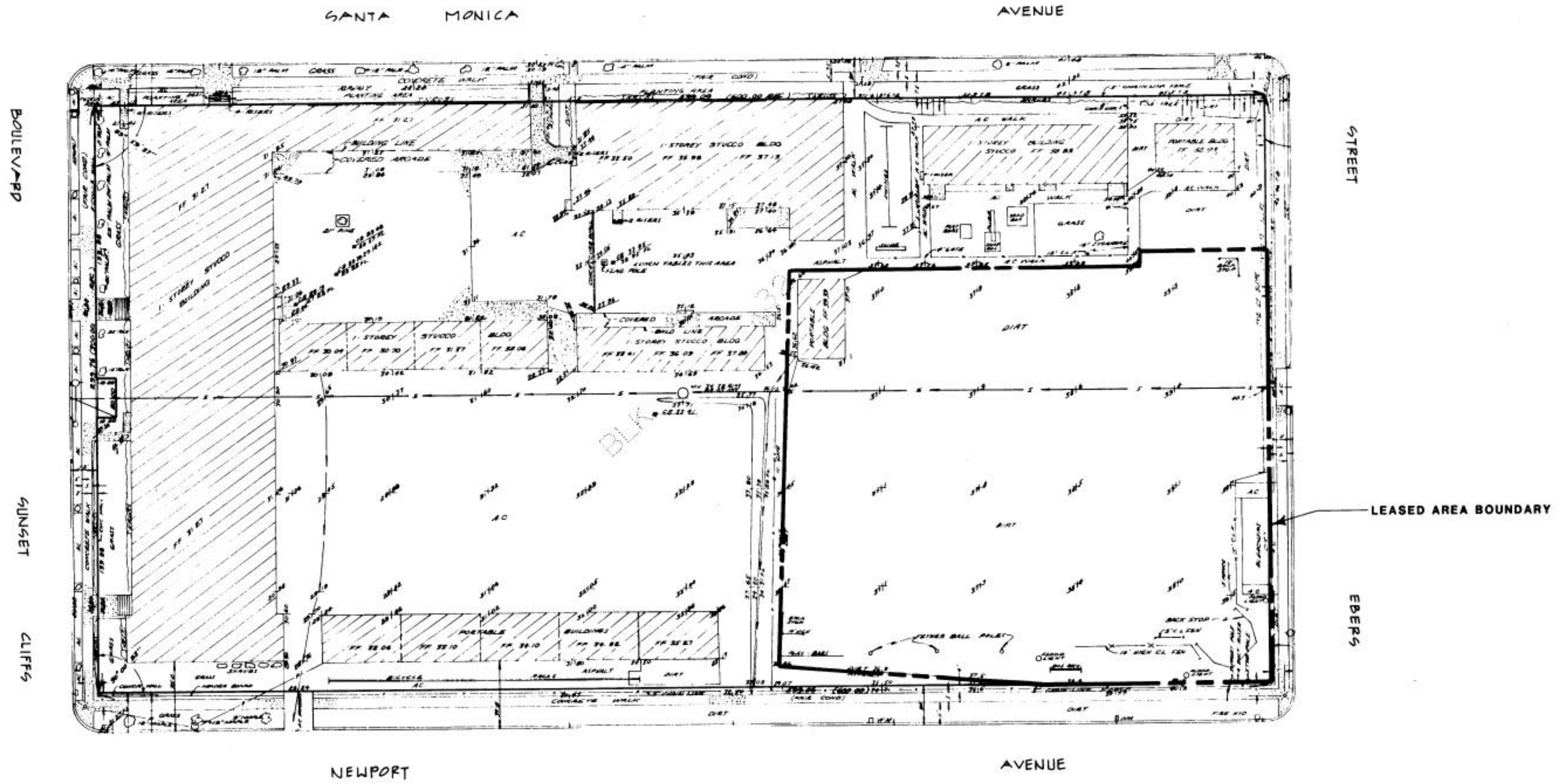

0 30' 60'  
GRAPHIC SCALE IN FEET



COUNCIL DISTR 2    COMM. PLAN AREA ... OCEAN BEACH    P.S.D. 540

PREPARED BY S.D. UNIFIED SCHOOL DISTRICT

--- AREA MAINTAINED BY PARK & RECREATION DEPT.

DATA LOG FOR:

DATE	ACTION	REFERENCE DOCUMENTS
	SITE ACQUIRED	RESO. NO. COST # ACRES:
	SITE DEDICATED	ORD. NO. ACRES:
	GOP CONSULTANT HIRED	RESO. NO. NAME
	P&R BOARD APPROVAL	PF & R APPROVAL
	INITIAL DEVELOPMENT	CIP NO. JO. NO. DRWG. NO. 22895-D
		CIP NO. JO. NO. DRWG. NO.
		CIP NO. JO. NO. DRWG. NO.
		CIP NO. JO. NO. DRWG. NO.
		CIP NO. JO. NO. DRWG. NO.
		CIP NO. JO. NO. DRWG. NO.
7-26-77	LEASED, 29 YRS.	ORD. NO. 12114

IMPROVEMENTS SUMMARY (DATA FROM AS-BUILT DRAWINGS)

ITEM	QUANTITY	ITEM	QUANTITY	ITEM	QUANTITY	ITEM	QUANTITY
TOTAL SITE	AC	PLAY AREA	SF	PAVED WALKS	SF	SECURITY LTS	STDS
IMPROVED AREA	AC	MULTI PURPOSE CT	SF	PARK ROADS	SF	BALL FIELD LTS	4 STDS
TURF	AC	TENNIS CTS	SF	PARKING LOT	SF	TENNIS CT. LTS	STDS
SHRUB BED	AC	RESTROOM	SF	" " STALLS STD		MULTI PURPOSE CT	STDS
NATURAL	AC	REC. BLDG.	SF	" " STALLS HDCP			
OTHER LANDSCAPING	AC	POOL BLDG.	SF	COURT GAME AREA	SF	BACKSTOPS	EA
DIRT INFIELDS	AC	" " DECK	SF	" " DECK	SF	TENNIS CTS	EA
		" " WATER	SF	LAWN EDGING	LF		
DIRT FIELD 1.20 AC							

CITY OF SAN DIEGO    PARK and RECREATION DEPARTMENT

THE GENERAL DEVELOPMENT PLAN  
OCEAN BEACH ELEM. SCHOOL

4741 - SANTA MONICA AVE

LAMBERT  
COORDINATES 213-1694    THOMAS BROS. PG. 59, 64