

LOCATION MAP

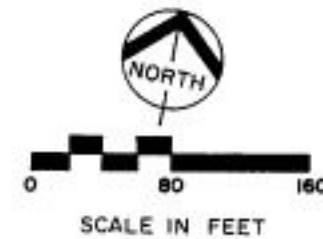
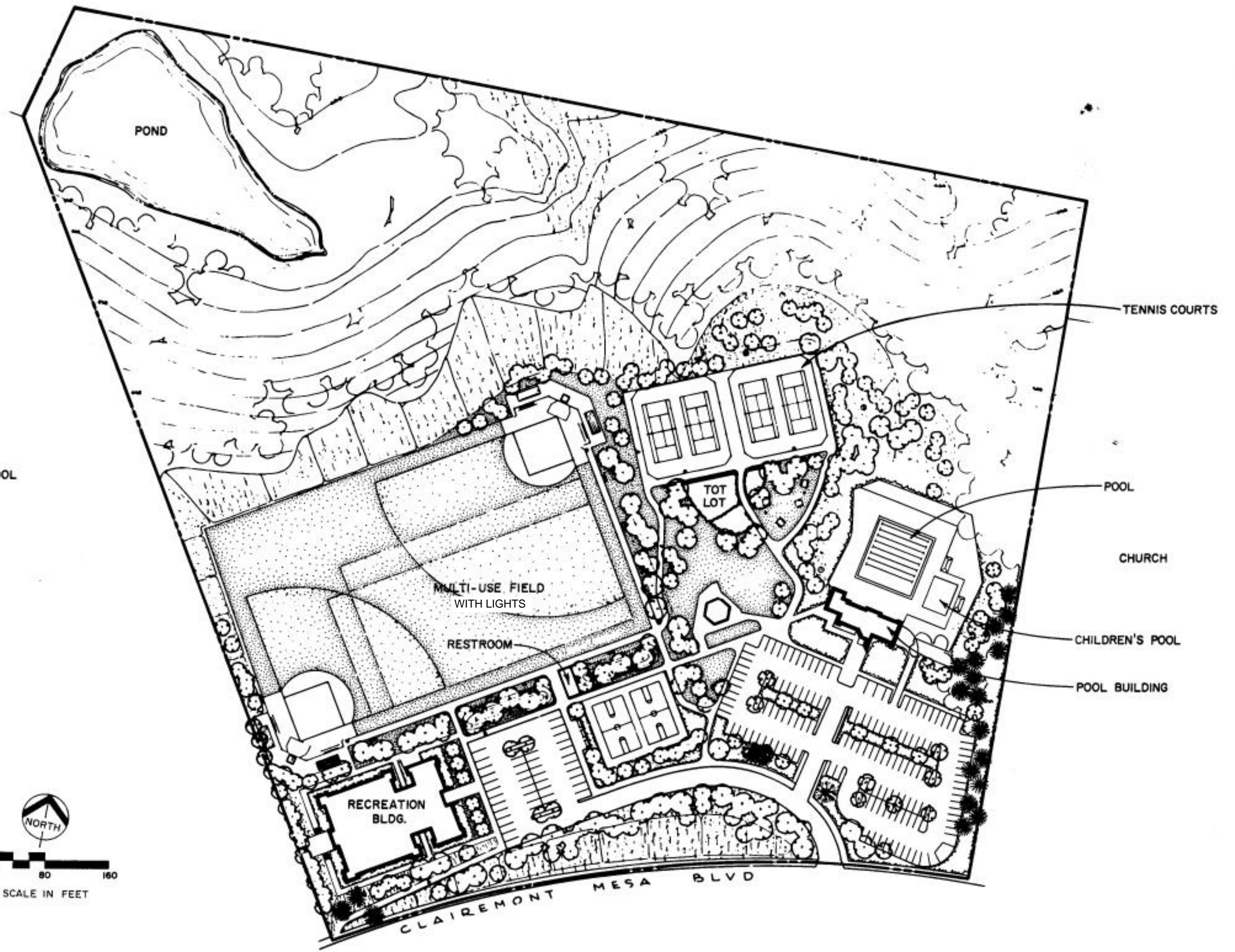

COUNCIL DISTR 7 COMM PLAN AREA TIERRASANTA 47 PSD 340

DATA LOG FOR		REFERENCE DOCUMENTS			
DATE	ACTION	RESO NO	R-194379	COST	ACRES
8-1-68	SITE ACQUIRED	RESO NO	R-194379	COST	ACRES 26.83
4-5-82	SITE DEDICATED	ORD NO	O-15716		ACRES 26.83
8-14-78	GDP CONSULTANT HIRED	RESO NO	R-221634	NAME	R. DEWEESE & ASSOC.
2-20-79	P&R BOARD APPROVAL	P.F. & R. APPROVAL		DATE	
7-14-80	INITIAL DEVELOPMENT	CIP NO	23-590	JO NO	117523 DRWG NO 18560-D
1-6-82	IMPROVEMENTS	CIP NO	23-590	JO NO	117523 DRWG NO 19656-D
6-87	LIBRARY W/BENCHES	CIP NO	23-590	JO NO	118409 DRWG NO 20990-D
1-24-91	RECREATION BLDG.	CIP NO		JO NO	118276 DRWG NO 24814-D
		CIP NO		JO NO	DRWG NO
		CIP NO		JO NO	DRWG NO

IMPROVEMENTS SUMMARY (DATA FROM AS-BUILT DRAWINGS)					
ITEM	QUANTITY	ITEM	QUANTITY	ITEM	QUANTITY
TOTAL SITE	26.83 AC	PLAY AREA	8,046 SF	PAVED WALKS	28,408 SF
IMPROVED AREA	13.89 AC	MULTI PURPOSE CT	11,700 SF	PARK ROADS	21,318 SF
TURF	6.22 AC	TENNIS CTS	21,328 SF	PARKING LOT	24,770 SF
SHRUB BED	AC	RESTROOM	589 SF	" " STALLS STD	182
NATURAL	12.94 AC	LIBRARY BLDG.	916 SF	" " STALLS HDCP	6
OTHER LANDSCAPING	4.37 AC	POOL BLDG.	6,829 SF	COURT GAME AREA	SF
DIRT INFIELDS	.46 AC	" " DECK	SF	LAWN EDGING	5,975 LF
		" " WATER	7,352 SF		
		REC. BLDG.	17,644 SF		
				REVISION	T.R. 7/22/96

CITY OF SAN DIEGO		PARK and RECREATION DEPARTMENT	
<h1 style="margin: 0;">THE GENERAL DEVELOPMENT PLAN</h1> <h2 style="margin: 0;">TIERRASANTA</h2> <p style="margin: 0;">PARK AND RECREATION CENTER</p>			
COUNCIL DIST. NO. 7	COMM. PLAN AREA - TIERRASANTA	11220 CLAIREMONT MESA BLVD.	PSD
LAMBERT COORDINATES 242-1737		THOMAS BROS PG.1249, J-1	340