

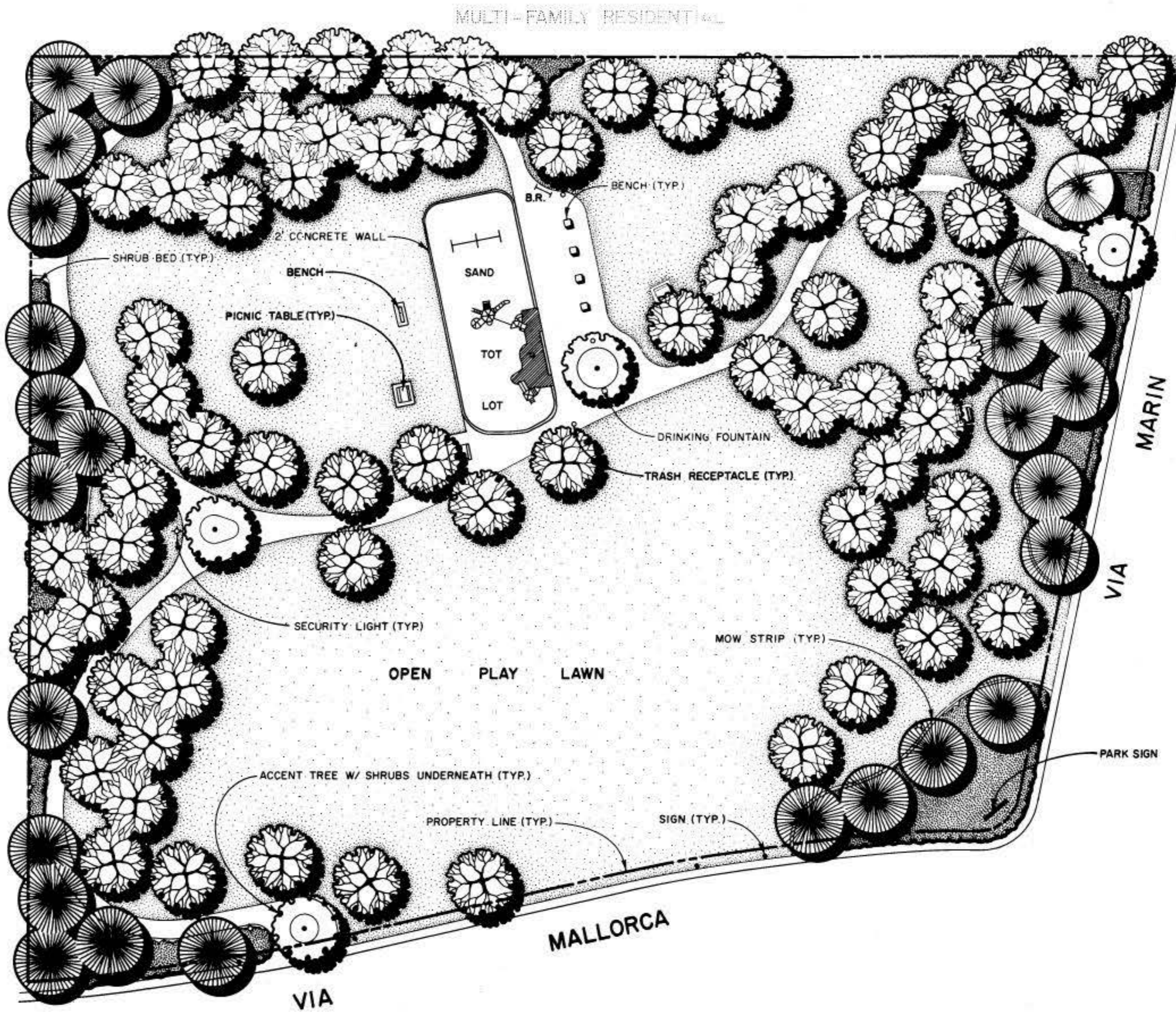

VICINITY MAP

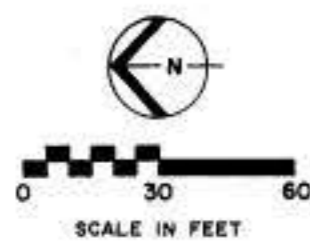

MULTI-FAMILY RESIDENTIAL

DATE	ACTION	REFERENCE DOCUMENTS	COST	ACRES
3/69	SITE ACQUIRED	RESO NO R-196445	30,000	5.60
4/82	SITE DEDICATED	ORD NO O-15720		5.60
		RESO NO	NAME <b>W.F. PURDY</b>	
5/80	P & R BOARD APPROVAL	P F & R APPROVAL		
	INITIAL DEVELOPMENT	CIP NO	JO NO 120010	DRWG NO 15680-D
5/14/79	IMPROVEMENTS	CIP NO	JO NO 117538	DRWG NO 17917-D
7/6/83	LIGHTING	CIP NO	JO NO 118089	DRWG NO 20251-D
8/20/90	TOT LOT	CIP NO 29-682	JO NO 119330	DRWG NO 25609-D
3/24/97	TOT LOT UPGRADE	CIP NO	JO NO 112582	DRWG NO 28048-D
		CIP NO	JO NO	DRWG NO

IMPROVEMENTS SUMMARY (DATA FROM AS-BUILT DRAWINGS)			
ITEM	QUANTITY	ITEM	QUANTITY
TOTAL SITE	5.60 AC	PLAY AREA	5,904 SF
IMPROVED AREA	5.69 AC	MULTI PURPOSE CT	SF
TURF	4.35 AC	TENNIS CTS	SF
SHRUB BED	.79 AC	RESTROOM	SF
NATURAL		REC. BLDG	SF
OTHER LANDSCAPING		POOL BLDG	SF
DIRT INFIELDS		" " DECK	SF
		" " WATER	SF
		PAVED WALKS	18,138 SF
		PARK ROADS	SF
		PARKING LOT	SF
		" " STALLS STD	
		" " STALLS HDCP	
		COURT GAME AREA	SF
		LAWN EDGING	28,350 LF
		SECURITY LTS	5 STDS
		BALL FIELD LTS	STDS
		TENNIS CT LTS	STDS
		MULTI PURPOSE CT	STDS
		PICNIC TABLES	4 EA
		BENCHES	4 EA
		DRINKING FOUNTAIN	1 EA
		BICYCLE RACK	1 EA

CITY OF SAN DIEGO	PARK and RECREATION DEPARTMENT
THE GENERAL DEVELOPMENT PLAN	
<b>VILLA LA JOLLA</b>	
NEIGHBORHOOD PARK	
COUNCIL DIST. NO. 1	COMM. PLAN AREA UNIVERSITY - 41
8371 VIA MALLORCA	
LAMBERT	COORDINATES 252-1697
THOMAS BROS	PG. 44, C-3
PSD NO.	
<b>481</b>	

REVISION T.R. 4/1/97