



THE CITY OF SAN DIEGO



ANNUAL REPORT for Fiscal Year 2019

ROBINHOOD RIDGE MAINTENANCE ASSESSMENT DISTRICT

under the provisions of the

**San Diego Maintenance Assessment District Procedural Ordinance
of the San Diego Municipal Code**

**Prepared For
City of San Diego, California**



**Prepared By
EFS Engineering, Inc.
P.O. Box 22370
San Diego, CA 92192-2370
(858) 752-3490**

May 2018

CITY OF SAN DIEGO

Mayor

Kevin Faulconer

City Council Members

Barbara Bry
District 1 (Council President Pro Tem)

Lorie Zapf
District 2

Chris Ward
District 3

Myrtle Cole
District 4 (Council President)

Mark Kersey
District 5

Chris Cate
District 6

Scott Sherman
District 7

David Alvarez
District 8

Georgette Gómez
District 9

City Attorney

Mara W. Elliott

Chief Operating Officer

Kris Michell

City Clerk

Elizabeth Maland

Independent Budget Analyst

Andrea Tevlin

City Engineer

James Nagelvoort

Table of Contents

Annual Report for Fiscal Year 2019

Robinhood Ridge Maintenance Assessment District

Preamble.....	1
Executive Summary	2
Background	3
District Boundary	3
Project Description.....	3
Separation of General and Special Benefits.....	4
Cost Estimate.....	4
Annual Cost-Indexing	4
Method of Apportionment.....	5
Estimated Benefit of Improvements.....	5
Apportionment Methodology	5
Equivalent Benefit Units (EBUs).....	5
Land Use Factor	5
Benefit Factor	7
Sample Calculations	9
Summary Results.....	10

EXHIBITS

Exhibit A: District Boundary

Exhibit B: Estimated Budget – Revenue & Expense Statement
for Fiscal Year 2019

Exhibit C: Preliminary Assessment Roll for Fiscal Year 2019

Annual Report for Fiscal Year 2019

Robinhood Ridge

Maintenance Assessment District

Preamble

Pursuant to §65.0220 of the “San Diego Maintenance Assessment District Procedural Ordinance” (being Division 2, Article 5, Chapter 6 of the *San Diego Municipal Code*) and City of San Diego Council Resolution No. R-310618 passed on July 22, 2016, authorizing the continued levy of assessments for the life of the ROBINHOOD RIDGE MAINTENANCE ASSESSMENT DISTRICT (hereinafter referred to as “District”), and in accordance with applicable provisions of “Proposition 218” (being Article XIII D of the California Constitution), and provisions of the “Proposition 218 Omnibus Implementation Act” (being California Senate Bill 919) (the aforementioned provisions are hereinafter referred to collectively as “applicable law”), and in accordance with Resolution No. _____, adopted by the CITY COUNCIL OF THE CITY OF SAN DIEGO, COUNTY OF SAN DIEGO, STATE OF CALIFORNIA, and in connection with the annual proceedings for the District, EFS Engineering, Inc., as Assessment Engineer to the City of San Diego, submits herewith this annual report for the District as required by §65.0220 of the “San Diego Maintenance Assessment District Procedural Ordinance.”

DATE OF FINAL PASSAGE BY THE CITY OF SAN DIEGO,
COUNTY OF SAN DIEGO, STATE OF CALIFORNIA, ON THE
_____ DAY OF _____, 2018.

Elizabeth Maland, CITY CLERK
CITY OF SAN DIEGO
STATE OF CALIFORNIA

Executive Summary

Project: Robinhood Ridge
Maintenance Assessment District

Apportionment Method: Equivalent Benefit Unit (EBU)

	FY 2018	FY 2019 ⁽¹⁾	Maximum ⁽²⁾ Authorized
Total Parcels Assessed:	620	620	--
Total Estimated Assessment:	\$83,888	\$83,888	--
Total Number of EBUs:	574.57	574.57	--
Assessment per EBU:	\$146.00	\$146.00	\$199.08 ⁽³⁾

⁽¹⁾ FY 2019 is the City's Fiscal Year 2019, which begins July 1, 2018 and ends June 30, 2019. Total Parcels Assessed, Total Estimated Assessment, and assessment apportionment factors may vary from prior fiscal year values due to parcel changes and/or land use re-classifications.

⁽²⁾ Maximum authorized assessment rate subject to cost-indexing as approved by property owners at the time of District formation.

⁽³⁾ Prior fiscal year's maximum authorized annual assessment rate increased by cost-indexing factor of 2.76%.

Annual Cost-Indexing: The maximum authorized assessment rates are cost-indexed and will increase (or decrease) annually based on the annual change in the *San Diego Consumer Price Index for Urban Consumers* (SDCPI-U).

Background

The Robinhood Ridge Maintenance Assessment District (District), originally known as the “Northwest Otay Mesa Maintenance Assessment District, Zone 2,” was established by the City of San Diego (City) on June 22, 1999 by City Council Resolution R-291812. The purpose of the District was, and still is, to fund specifically identified improvements and activities within the boundary of the District.

In conformity with §65.0221 of the “San Diego Maintenance Assessment District Procedural Ordinance,” the City adopted Resolution No. R-310618 on July 22, 2016, approving the annual budget and assessments for Fiscal Year 2017, and authorizing the levy of the assessments for the life of the District, consistent with the benefit findings and assessment apportionment method contained in the approved formational and all subsequently updated Engineer’s Reports (Engineer’s Reports). The Engineer’s Reports are on file with the City Clerk, and incorporated herein by reference.

The District is authorized and administered under the provisions of the “San Diego Maintenance Assessment District Procedural Ordinance.” This annual report has been prepared pursuant to the requirements of §65.0220 of the “San Diego Maintenance Assessment District Procedural Ordinance.”

District Boundary

The District boundary is generally depicted in **Exhibit A**. The District Boundary Map and Assessment Diagram are on file in the Maintenance Assessment Districts section of the Parks and Recreation Department of the City, and, by reference, are made a part of this annual report.

Project Description

The authorized assessments will be used to fund specifically identified improvements and activities within the District. The District improvements and activities generally consist of maintenance and servicing of specified landscaped rights-of-way and natural open space areas in the District. The approximate location of the improvements is generally shown on **Exhibit A**.

For additional detail as to the location, type of improvements, and activities performed by the District, please refer to the maps, improvement plans, engineering drawings, maintenance specifications,

the Engineer's Reports and other associated documents on file with the Maintenance Assessment Districts section of the Parks and Recreation Department of the City. These documents, collectively, are incorporated herein by reference and made part of this annual report.

Separation of General and Special Benefits

The identified improvements and activities provide benefits to the parcels located within the District. These benefits are "special benefits" to the extent that they are above and beyond the City's standard level of service, and exclusive of those "general benefits" provided to the public at large or properties located outside the District. By law, only "special benefits" are assessable.

The assessments presented in this annual report are based on the cost of improvements and activities determined to provide "special benefits" in accordance with the Engineer's Reports. For additional detail relative to the separation and quantification of general and special benefits for the District, please refer to the Engineer's Reports, on file with the Maintenance Assessment Districts section of the Parks and Recreation Department of the City.

Cost Estimate

The estimated annual budget (Revenue & Expense Statement) for Fiscal Year 2019 (July 1, 2018 to June 30, 2019 period) is included as **Exhibit B**. The "Other Contributions (Non Assessment Source)" revenue contained in the budget includes the value of improvements and activities determined to provide "general benefits." The District budget with full detail is available for public reference in the Maintenance Assessment Districts section of the Parks and Recreation Department of the City.

Annual Cost-Indexing

The maximum authorized assessment set forth in the Engineer's Reports is permitted to increase annually based on the published change in the "San Diego Consumer Price Index for Urban Consumers" (SDCPI-U). The annual change in second half SDCPI-U values, as compiled by the *U.S. Bureau of Labor Statistics* (see www.bls.gov), for the prior year period was from 276.837 to 284.464 (a 2.76% increase). In accordance with the approved cost-indexing provisions, the maximum authorized assessment rates have been increased by 2.76%.

Method of Apportionment

Estimated Benefit of Improvements

The Transportation Element of the City's General Plan and the general policy recommendations found in the Otay Mesa Community Plan establish several goals for the community's transportation system. The District improvements and activities are consistent with the plans' goals for safety and pleasing aesthetics. The major and arterial streets within the District are the backbone of the street network within the community. They serve as the primary access routes for inter-community and intra-community trips. The collector/neighborhood streets within the District serve as the primary access routes to and from the major and arterial streets for parcels within a neighborhood.

Apportionment Methodology

The total cost associated with District improvement and activities will be assessed proportionally to the parcels in the District based on Equivalent Benefit Units (EBUs). The total assessment for a given parcel is equal to the parcel's total EBUs multiplied by the Unit Assessment Rate (unique to the zone in which parcel is situated) as shown in the following equation:

$$\text{Total Assessment} = \text{Total EBUs} \times \text{Unit Assessment Rate}$$

Equivalent Benefit Units (EBUs)

EBUs for each parcel have been determined as a function of two factors, a Land Use Factor and a Benefit Factor, related as shown in the following equation:

$$\text{EBUs} = (\text{Acres or Units}) \times \text{Land Use Factor} \times \text{Benefit Factor}$$

Each of these factors is discussed below.

Land Use Factor

Since the District improvements and activities are primarily associated with the Transportation Element of the General and Community Plans, trip generation rates for various land use categories (as previously established by the City's Transportation Planning Section) have been used as the primary basis for the development of Land Use Factors. While these trip generation rates strictly address only vehicular trips, they are also considered

to approximately reflect relative trip generation for other modes of transportation (e.g., pedestrian trips, bicycle trips, etc.), and are considered the best available information for these other transportation modes.

The special benefits of the District improvements and activities are linked to trip generation primarily by the public safety and aesthetic enhancement enjoyed by travelers through the community. Trip generation rates provide the required nexus and basis for assigning ratios of maximum potential benefit to the various land use/zoning classifications as defined by the City’s Municipal Code.

Land use/zoning classifications have been grouped with averaged trip generation rates assigned to establish the Land Use Factors as shown in **Table 1**.

TABLE 1: Land Use Factors

Land Use/Zoning	Code	Land Use Factor
Residential – Single Family (detached)	SFD	1.0 per dwelling unit
Residential – Condominium	CND	0.7 per dwelling unit
Residential – Multi-Family & Apartment	MFR	0.7 per dwelling unit
Commercial – Office & Retail	COM	45.0 per acre
Educational – Primary & Secondary	EPS	5.0 per acre
Fire/Police Station	FPS	15.0 per acre
House of Worship	CRH	2.8 per acre
Industrial	IND	15.0 per acre
Open Space (designated)	OSP	0.0 per acre
Park – Developed	PKD	5.0 per acre
Park – Undeveloped	PKU	0.5 per acre
Undevelopable	UND	0.0 per acre

Designated Open Space serves primarily to preserve natural landscape and habitat. While access for study and passive recreation is sometimes permitted, these activities are usually allowed only to the limited extent consistent with the primary purpose of natural preservation. Since this land is essentially “unused” in the customary terms of land use (which relate to human use, not use by nature), the trip generation rate is zero. Therefore, the designated Open Space receives no benefit from the Transportation Element and has been assigned a Land Use Factor of zero.

Benefit Factor

The Land Use Factor described above reflects the relative intensity of use (or potential use) of the various parcels of land to be assessed. It does not address the relationship of this use to the specific District improvements and activities. This relationship is reflected in the Benefit Factor utilized in the assessment methodology.

In determining the Benefit Factor for each land use category, the subcomponents of the benefits of District improvements and activities considered may include some or all of the following: public safety, view corridors and aesthetics, enhancement of community identity, drainage corridors, and recreational potential. As Benefit Factors and their subcomponents are intended to reflect the particular relationships between specific land uses within a district and the specific District improvements and activities, Benefit Factors will generally vary from one district to another, based on the specific character and nature of the applicable land uses and improvements and activities.

The applicable benefit subcomponents and resultant composite Benefit Factors determined for the various land use/zoning categories within this District are as shown in **Table 2**.

TABLE 2: Benefit Factors by Land Use

Land Use/Zoning	Public Safety (max. 0.4)	Aesthetics (max. 0.6)	Composite Benefit Factor (max. 1.0)
Residential – All	0.4	0.6	1.0
Commercial – Office & Retail	0.4	0.3	0.7
Educational – Primary & Secondary	0.4	0.3	0.7
Fire/Police Station	0.4	0.3	0.7
House of Worship	0.4	0.3	0.7
Industrial	0.4	0.3	0.7
Open Space (designated)	0.4	0.0	0.4
Park – Developed	0.4	0.0	0.4
Park – Undeveloped	0.4	0.0	0.4
Undevelopable	0.4	0.0	0.4

Public Safety. All land uses are considered to receive the maximum available benefit from the public safety element of District improvements and activities. Public safety is essential to all land uses, and even to lands, such as designated Open Space, held in stewardship with only incidental human use.

Aesthetics. The degree of benefit received from the aesthetic qualities of landscaped and hardscaped roadway medians and rights-of-way maintained by the District varies among land use categories. Generally, by nature of their use, residential lands receive the greatest benefit from the reduced traffic congestion, reduced noise levels, greater separation from traffic and generally more tranquil environment provided by landscaped and hardscaped roadway medians and rights-of-way. Commercial, industrial and institutional uses, on the other hand, often thrive on higher densities, greater traffic access, and a higher level of activity in the vicinity of their enterprises. These uses, accordingly, receive a lesser degree of benefit from the general insulation and separation provided by the aesthetic elements of District improvements and activities.

Lands in the Open Space category are considered to receive no significant benefit from the aesthetic elements of District improvements and activities, as enhanced aesthetic quality of other lands in the vicinity does not affect their function, use, or value. Lands in the Park category are considered to receive no significant benefit from the aesthetic elements of District improvements and activities, as the aesthetic values of these lands are themselves so high that they are little enhanced by those of other lands in their vicinity.

Sample Calculations

As described above, the number of Equivalent Benefit Units (EBUs) assigned to each parcel in the District has been calculated based on each parcel's land use and the identified apportionment factors, as shown in the following equation:

$$\text{EBUs} = (\text{Acres or Units}) \times \text{Land Use Factor} \times \text{Benefit Factor}$$

Shown below are sample EBU calculations for several common land uses found in the District.

- **1 Single-Family Residence**
EBUs = 1 unit x 1.00 x 1.00 = 1.00 EBUs
- **1 Condominium**
EBUs = 1 unit x 0.70 x 1.00 = 0.70 EBUs
- **10-unit Apartment Complex**
EBUs = 10 units x 0.70 x 1.00 = 7.00 EBUs
- **½-acre Commercial Property**
EBUs = 0.50 acres x 45.00 x 0.70 = 15.75 EBUs

The total assessment for each parcel in the District is based on the calculated EBUs for the parcel and the applicable unit assessment rate, as shown in the following equation:

$$\text{Total Assessment} = \text{Total EBUs} \times \text{Unit Assessment Rate}$$

Based on the above formula, the EBUs, unit assessment rate, and total assessment calculated for each property, can be found in the Assessment Roll (**Exhibit C**).

Summary Results

The District Boundary is presented in **Exhibit A**.

An estimate of the annual costs of the improvements and activities provided by the District is included as **Exhibit B**.

The assessment methodology utilized is as described in the text of this annual report. Based on this methodology, Fiscal Year 2019 District assessment for each parcel were calculated and are shown in the Preliminary Assessment Roll (**Exhibit C**).

Each lot or parcel of land within the District has been identified by unique County Assessor's Parcel Number in the Preliminary Assessment Roll and on the Boundary Map and Assessment Diagram referenced herein.

This annual report has been prepared and respectfully submitted by:

EFS ENGINEERING, INC.



Eugene F. Shank, PE

C 52792

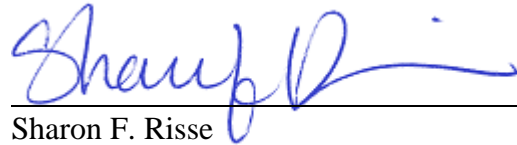

Sharon F. Risse

EXHIBIT A

District Boundary

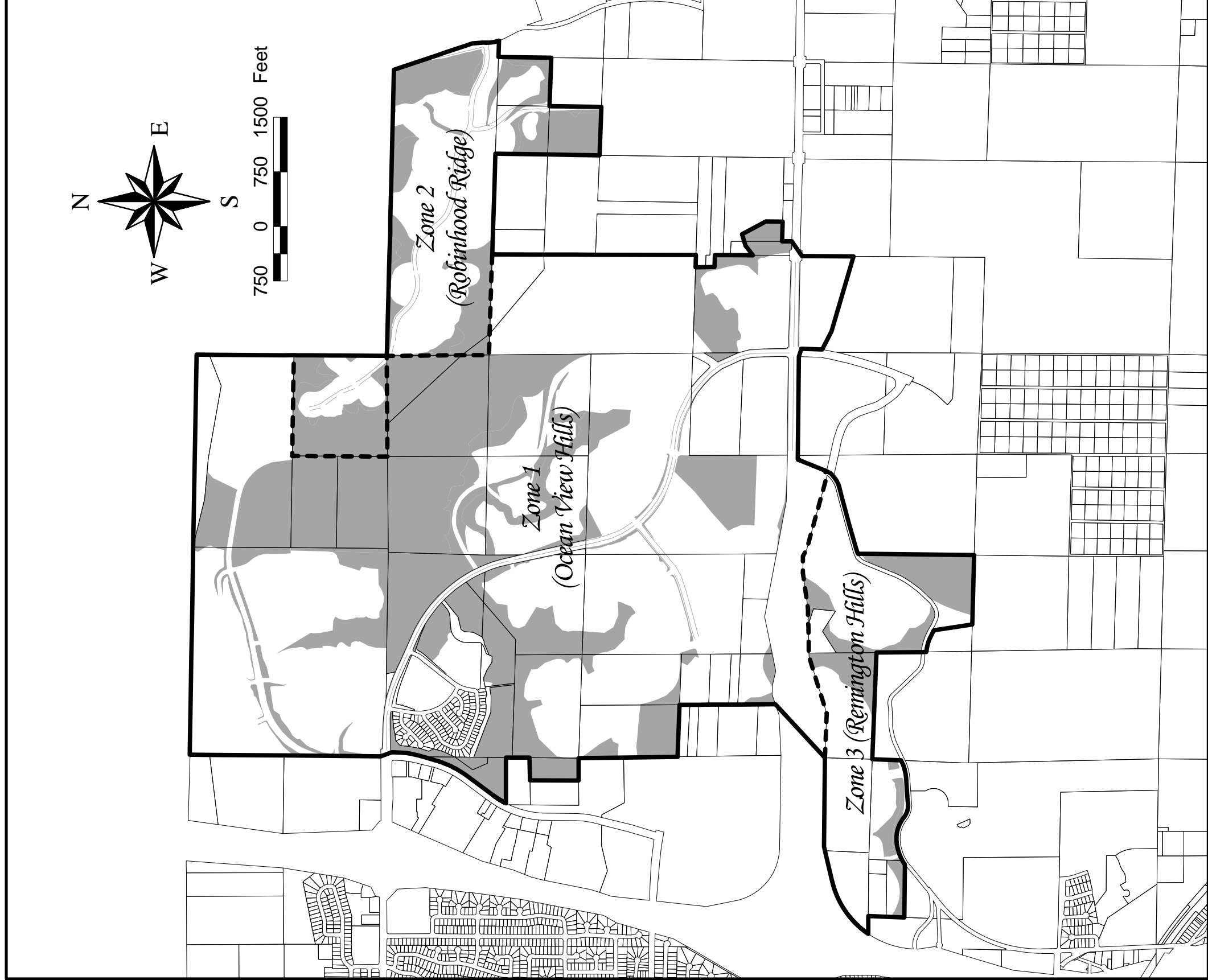

NOTE

1. This map is for exhibit purposes only. Please refer to the Northwest Otay Mesa Maintenance Assessment District Boundary Map on file at the City.
2. Each lot or parcel on this map has been identified by the County Assessor's Parcel Number in the Assessment Roll contained in the Engineer's Report.
3. For a detailed description of the lines and dimensions of lots or parcels shown on this map, refer to the County Assessor's Maps which shall govern with respect to all details concerning the lines and dimensions of such lots or parcels.

LEGEND

- District Boundary
- Zone Boundary
- Parcel Lines
- Improvements

CITY OF SAN DIEGO / NORTHWEST OTAY MESA MAINTENANCE ASSESSMENT DISTRICT

EXHIBIT A - District Boundary, Zones & Improvements

EXHIBIT B

**Estimated Budget – Revenue & Expense Statement
for Fiscal Year 2019**

EXHIBIT B

REVENUE AND EXPENSE STATEMENT

Robinhood Ridge Maintenance Assessment District Fund 200097

	<u>FY 2017 ACTUALS</u>	<u>FY 2018 ESTIMATE</u>	<u>FY 2019 PROPOSED</u>
BEGINNING FUND BALANCE			
Surplus (or Deficit) from Prior Year	\$ 123,390.49	\$ 123,188.00	\$ 113,189.00
TOTAL BEGINNING FUND BALANCE	\$ 123,390.49	\$ 123,188.00	\$ 113,189.00
REVENUE			
Assessment Revenue	\$ 84,345.42	\$ 83,887.00	\$ 83,887.80
Interest	\$ 1,157.96	\$ 1,000.00	\$ 800.00
Other Contributions (Non Assessment Source)	\$ 6,062.00	\$ 7,907.00	\$ 6,864.00
TOTAL REVENUE	\$ 91,565.38	\$ 92,794.00	\$ 91,551.80
TOTAL BEGINNING FUND BALANCE & REVENUE	\$ 214,955.87	\$ 215,982.00	\$ 204,740.80
OPERATING EXPENSE			
Landscaping Improvements and Activities ⁽¹⁾	\$ 54,586.00	\$ 69,438.00	\$ 71,566.00
Tree Services	\$ 3,663.71	\$ 5,000.00	\$ 5,000.00
Misc. Services ⁽²⁾	\$ -	\$ 1,000.00	\$ 1,000.00
Special Districts Administration Cost	\$ 33,518.00	\$ 27,355.00	\$ 29,148.00
Other (Unallocated Reserve)	\$ -	\$ -	\$ -
TOTAL OPERATING EXPENSE	\$ 91,767.71	\$ 102,793.00	\$ 106,714.00
TOTAL EXPENSE	\$ 91,767.71	\$ 102,793.00	\$ 106,714.00
TOTAL ENDING FUND BALANCE	\$ 123,188.16	\$ 113,189.00	\$ 98,026.80
NET ANNUAL REVENUE (OR EXPENSE)	\$ (202.33)	\$ (9,999.00)	\$ (15,162.20)

⁽¹⁾ Includes utility costs.

⁽²⁾ Includes fence and gate installation services.

The District budget with full detail is available for public reference in the Maintenance Assessment Districts section of the Parks and Recreation Department of the City of San Diego.

EXHIBIT C

**Preliminary Assessment Roll
for Fiscal Year 2019**

EXHIBIT C - Assessment Roll (Fiscal Year 2019)

Robinhood Ridge Maintenance Assessment District

Parcel Number	Acres/ Units ⁽¹⁾	Land Use ⁽²⁾	NW Otay Zone	Apportionment Factors		Total EBUS	Unit Cost (\$/EBU)	FY 2019 ⁽⁴⁾ Assessment	Owner Name
				Land Use ⁽²⁾	Benefit ⁽³⁾				
645 051 04 00	14.45	OSP	2	0.00	0.40	0.00	\$146.00	\$0.00	City Of San Diego
645 051 05 00	1.12	OSP	2	0.00	0.40	0.00	\$146.00	\$0.00	Greystone Homes Inc
645 230 01 00	1.00	SFD	2	1.00	1.00	1.00	\$146.00	\$146.00	Zito Jack J&Petra
645 230 02 00	1.00	SFD	2	1.00	1.00	1.00	\$146.00	\$146.00	Keema John M Jr&Maria T <Dva>
645 230 03 00	1.00	SFD	2	1.00	1.00	1.00	\$146.00	\$146.00	Canlas Dennis C&Joy B
645 230 04 00	1.00	SFD	2	1.00	1.00	1.00	\$146.00	\$146.00	Salazar Erasmo A
645 230 05 00	1.00	SFD	2	1.00	1.00	1.00	\$146.00	\$146.00	Hembera Trevor Jon&Griselda
645 230 06 00	1.00	SFD	2	1.00	1.00	1.00	\$146.00	\$146.00	Rodriguez Sylvia E
645 230 07 00	1.00	SFD	2	1.00	1.00	1.00	\$146.00	\$146.00	Rodriguez Rigoberto&Ronda L
645 230 08 00	1.00	SFD	2	1.00	1.00	1.00	\$146.00	\$146.00	Enriquez Alfredo R&Yolanda
645 230 09 00	1.00	SFD	2	1.00	1.00	1.00	\$146.00	\$146.00	Ramos Shawn S&Lennie E
645 230 10 00	1.00	SFD	2	1.00	1.00	1.00	\$146.00	\$146.00	Galvez Jose D J
645 230 11 00	1.00	SFD	2	1.00	1.00	1.00	\$146.00	\$146.00	Gaza Family Trust 02-09-06
645 230 12 00	1.00	SFD	2	1.00	1.00	1.00	\$146.00	\$146.00	Valaskantjis Margitsa M
645 230 13 00	1.00	SFD	2	1.00	1.00	1.00	\$146.00	\$146.00	Agundez Robert
645 230 14 00	1.00	SFD	2	1.00	1.00	1.00	\$146.00	\$146.00	Torres Emery S&Maria C
645 230 15 00	1.00	SFD	2	1.00	1.00	1.00	\$146.00	\$146.00	Vargas Arturo G&Chiquete Imelda S
645 230 16 00	1.00	SFD	2	1.00	1.00	1.00	\$146.00	\$146.00	Nguyen Tuan H&Phuong T
645 230 17 00	1.00	SFD	2	1.00	1.00	1.00	\$146.00	\$146.00	Hawkins Daniel W
645 230 18 00	1.00	SFD	2	1.00	1.00	1.00	\$146.00	\$146.00	Ruvalcaba Pedro
645 230 19 00	1.00	SFD	2	1.00	1.00	1.00	\$146.00	\$146.00	Sortdesanz Patricia G
645 230 20 00	1.00	SFD	2	1.00	1.00	1.00	\$146.00	\$146.00	Villanueva Emilia Revocable 2014 Trust
645 230 21 00	1.00	SFD	2	1.00	1.00	1.00	\$146.00	\$146.00	Chee Adriana
645 230 22 00	1.00	SFD	2	1.00	1.00	1.00	\$146.00	\$146.00	Lozano Jose A&Cynthia
645 230 23 00	1.00	SFD	2	1.00	1.00	1.00	\$146.00	\$146.00	Ruiz Jorge S
645 230 24 00	1.00	SFD	2	1.00	1.00	1.00	\$146.00	\$146.00	Zapanta Edward M&Joan U
645 230 25 00	1.00	SFD	2	1.00	1.00	1.00	\$146.00	\$146.00	Snow Michael L&Alysia D
645 230 32 00	1.00	SFD	2	1.00	1.00	1.00	\$146.00	\$146.00	Bass Shamar&Carla
645 230 33 00	1.00	SFD	2	1.00	1.00	1.00	\$146.00	\$146.00	Mcgaughy Marilyn M
645 230 37 00	1.00	SFD	2	1.00	1.00	1.00	\$146.00	\$146.00	Agyeman Kofi&Anita I
645 230 38 00	1.00	SFD	2	1.00	1.00	1.00	\$146.00	\$146.00	Zambrano Mario&Edna M
645 230 39 00	1.00	SFD	2	1.00	1.00	1.00	\$146.00	\$146.00	Gelacio Romel R
645 230 40 00	1.00	SFD	2	1.00	1.00	1.00	\$146.00	\$146.00	Hipolito Family Trust 05-27-05
645 230 41 00	1.00	SFD	2	1.00	1.00	1.00	\$146.00	\$146.00	Dominguez Juan Q Jr&Marisela
645 230 42 00	1.00	SFD	2	1.00	1.00	1.00	\$146.00	\$146.00	Gaiter Jerry
645 230 43 00	1.00	SFD	2	1.00	1.00	1.00	\$146.00	\$146.00	Henry Courtney&Jessica A
645 230 44 00	1.00	SFD	2	1.00	1.00	1.00	\$146.00	\$146.00	Ramirez Fernando&Christina R
645 230 45 00	1.00	SFD	2	1.00	1.00	1.00	\$146.00	\$146.00	Leon Joseph Jr&Erika J
645 230 46 00	1.00	SFD	2	1.00	1.00	1.00	\$146.00	\$146.00	Romero Nancy
645 230 47 00	1.00	SFD	2	1.00	1.00	1.00	\$146.00	\$146.00	Im John J&Montserrat
645 230 48 00	1.00	SFD	2	1.00	1.00	1.00	\$146.00	\$146.00	Kitchens Roddreck L&Susan Y
645 230 51 00	1.00	SFD	2	1.00	1.00	1.00	\$146.00	\$146.00	Lozano Benjamin&Jessica L
645 230 52 00	1.00	SFD	2	1.00	1.00	1.00	\$146.00	\$146.00	Salvania Benjamin V&Virginia F
645 230 53 00	1.00	SFD	2	1.00	1.00	1.00	\$146.00	\$146.00	Pacheco Rodolfo&Rene
645 230 54 00	1.00	SFD	2	1.00	1.00	1.00	\$146.00	\$146.00	Hoang Trung&Dan
645 230 55 00	1.00	SFD	2	1.00	1.00	1.00	\$146.00	\$146.00	Lacsina Joseph A&Rea F
645 230 56 00	1.00	SFD	2	1.00	1.00	1.00	\$146.00	\$146.00	Ramirez Jamie
645 230 57 00	1.00	SFD	2	1.00	1.00	1.00	\$146.00	\$146.00	Luckesen John D&Katherine M
645 230 58 00	1.00	SFD	2	1.00	1.00	1.00	\$146.00	\$146.00	Navarro Christian&Logan Amanda K
645 230 59 00	1.00	SFD	2	1.00	1.00	1.00	\$146.00	\$146.00	Sotos John V&Imelda
645 231 01 00	1.00	SFD	2	1.00	1.00	1.00	\$146.00	\$146.00	Ramirez Miguel
645 231 02 00	1.00	SFD	2	1.00	1.00	1.00	\$146.00	\$146.00	Fuentes Antonio
645 231 03 00	1.00	SFD	2	1.00	1.00	1.00	\$146.00	\$146.00	Nguyen Victoria
645 231 04 00	1.00	SFD	2	1.00	1.00	1.00	\$146.00	\$146.00	Coco Anthony&Junko
645 231 05 00	1.00	SFD	2	1.00	1.00	1.00	\$146.00	\$146.00	Santos Wilson T&Severina S
645 231 06 00	1.00	SFD	2	1.00	1.00	1.00	\$146.00	\$146.00	Jones Michael&Chong-Hui
645 231 07 00	1.00	SFD	2	1.00	1.00	1.00	\$146.00	\$146.00	Diaz Cynthia
645 231 08 00	1.00	SFD	2	1.00	1.00	1.00	\$146.00	\$146.00	Velasco Francisco J&Sandra
645 231 09 00	1.00	SFD	2	1.00	1.00	1.00	\$146.00	\$146.00	Chavarin Roberto&Leticia
645 231 10 00	1.00	SFD	2	1.00	1.00	1.00	\$146.00	\$146.00	Fuiava Bert P&Kimberly M L
645 231 11 00	1.00	SFD	2	1.00	1.00	1.00	\$146.00	\$146.00	Williams Harold R&Delra C

EXHIBIT C - Assessment Roll (Fiscal Year 2019)

Robinhood Ridge Maintenance Assessment District

Parcel Number	Acres/ Units ⁽¹⁾	Land Use ⁽²⁾	NW Otay Zone	Apportionment Factors		Total EBUS	Unit Cost (\$/EBU)	FY 2019 ⁽⁴⁾ Assessment	Owner Name
				Land Use ⁽²⁾	Benefit ⁽³⁾				
645 231 12 00	1.00	SFD	2	1.00	1.00	1.00	\$146.00	\$146.00	Valentine Norman M&Margaret A
645 231 13 00	1.00	SFD	2	1.00	1.00	1.00	\$146.00	\$146.00	Meyers Mark E&Corey A
645 231 14 00	1.00	SFD	2	1.00	1.00	1.00	\$146.00	\$146.00	Wacht Family Trust 01-13-16
645 231 15 00	1.00	SFD	2	1.00	1.00	1.00	\$146.00	\$146.00	Carrillo Carlos Trust A 06-11-07
645 231 16 00	1.00	SFD	2	1.00	1.00	1.00	\$146.00	\$146.00	Magalso Myrick J
645 231 17 00	1.00	SFD	2	1.00	1.00	1.00	\$146.00	\$146.00	Viramontes Fidencio&Raquel
645 231 18 00	1.00	SFD	2	1.00	1.00	1.00	\$146.00	\$146.00	Amezcuca Rafael&Jimenez-Amezcuca Celina M
645 231 19 00	1.00	SFD	2	1.00	1.00	1.00	\$146.00	\$146.00	Osorio Juan R&Mariel J
645 231 20 00	1.00	SFD	2	1.00	1.00	1.00	\$146.00	\$146.00	Nona Kamal H
645 231 21 00	1.00	SFD	2	1.00	1.00	1.00	\$146.00	\$146.00	Lee Richard N&Finkral Amanda
645 231 22 00	1.00	SFD	2	1.00	1.00	1.00	\$146.00	\$146.00	Boone William L Jr&Lucy A
645 231 23 00	1.00	SFD	2	1.00	1.00	1.00	\$146.00	\$146.00	Gonzalez Angel&Madrigal Jose Living Trust 04-26-02
645 231 24 00	1.00	SFD	2	1.00	1.00	1.00	\$146.00	\$146.00	Arellano Ruben
645 231 25 00	1.00	SFD	2	1.00	1.00	1.00	\$146.00	\$146.00	Lloyd Michael&Dina
645 231 26 00	1.00	SFD	2	1.00	1.00	1.00	\$146.00	\$146.00	Sloop Thomas R&Hye Suk
645 231 27 00	1.00	SFD	2	1.00	1.00	1.00	\$146.00	\$146.00	Rico Jerry J F&Marilyn M
645 231 28 00	1.00	SFD	2	1.00	1.00	1.00	\$146.00	\$146.00	Libed Ruben N&Jacqueline M
645 231 29 00	24.91	OSP	2	0.00	0.40	0.00	\$146.00	\$0.00	City Of San Diego
645 240 01 00	1.00	SFD	2	1.00	1.00	1.00	\$146.00	\$146.00	Noriega Luis M H Jr&Herroz Melissa
645 240 02 00	1.00	SFD	2	1.00	1.00	1.00	\$146.00	\$146.00	Arreola Menchie R
645 240 03 00	1.00	SFD	2	1.00	1.00	1.00	\$146.00	\$146.00	Cortez Family Trust 07-31-03
645 240 04 00	1.00	SFD	2	1.00	1.00	1.00	\$146.00	\$146.00	Jauregui Reynaldo&Norma
645 240 05 00	1.00	SFD	2	1.00	1.00	1.00	\$146.00	\$146.00	Herrera Abelardo L&Susan C Revocable Living Trust 05-0
645 240 06 00	1.00	SFD	2	1.00	1.00	1.00	\$146.00	\$146.00	Allphin James&Roxanne
645 240 07 00	1.00	SFD	2	1.00	1.00	1.00	\$146.00	\$146.00	Maldonado Jason&Guadalupe A
645 240 08 00	1.00	SFD	2	1.00	1.00	1.00	\$146.00	\$146.00	Castillo Edith
645 240 09 00	1.00	SFD	2	1.00	1.00	1.00	\$146.00	\$146.00	Pena Miguel
645 240 10 00	1.00	SFD	2	1.00	1.00	1.00	\$146.00	\$146.00	Fortin Raymundo&Thuyvi
645 240 11 00	1.00	SFD	2	1.00	1.00	1.00	\$146.00	\$146.00	Lopez Juan C
645 240 12 00	1.00	SFD	2	1.00	1.00	1.00	\$146.00	\$146.00	Martinez Richard&Alma
645 240 13 00	1.00	SFD	2	1.00	1.00	1.00	\$146.00	\$146.00	Burca-Nation Nina&Nation Ronessa
645 240 14 00	1.00	SFD	2	1.00	1.00	1.00	\$146.00	\$146.00	Payabyab Jose A Jr&Ligaya D Trs
645 240 15 00	1.00	SFD	2	1.00	1.00	1.00	\$146.00	\$146.00	Ramos Gustavo&Mayra
645 240 16 00	1.00	SFD	2	1.00	1.00	1.00	\$146.00	\$146.00	Shuey Sam P&Jessica A
645 240 17 00	1.00	SFD	2	1.00	1.00	1.00	\$146.00	\$146.00	Guzman Marcos A&Cruz-Figueroa Anahi
645 240 18 00	1.00	SFD	2	1.00	1.00	1.00	\$146.00	\$146.00	Garcia Gerardo L&Lozano Allison A
645 240 19 00	1.00	SFD	2	1.00	1.00	1.00	\$146.00	\$146.00	Irving Carlton C&Lambert Johnnie M
645 240 20 00	1.00	SFD	2	1.00	1.00	1.00	\$146.00	\$146.00	Montes Ricardo U&Norma E
645 240 21 00	1.00	SFD	2	1.00	1.00	1.00	\$146.00	\$146.00	Martinez Elizabeth A
645 240 22 00	1.00	SFD	2	1.00	1.00	1.00	\$146.00	\$146.00	Ventura Geoffrey&Divina M
645 240 23 00	1.00	SFD	2	1.00	1.00	1.00	\$146.00	\$146.00	Celestino Alex D&Editha A
645 240 24 00	1.00	SFD	2	1.00	1.00	1.00	\$146.00	\$146.00	Serrano George M&Caroline L
645 240 25 00	1.00	SFD	2	1.00	1.00	1.00	\$146.00	\$146.00	Gonzalez Marco A&Cecilia
645 240 26 00	1.00	SFD	2	1.00	1.00	1.00	\$146.00	\$146.00	Desmond Family Trust 05-31-16
645 240 27 00	1.00	SFD	2	1.00	1.00	1.00	\$146.00	\$146.00	Wold Thomas A&Karin L
645 240 28 00	1.00	SFD	2	1.00	1.00	1.00	\$146.00	\$146.00	Ottinger Joseph B Jr&Pakhlevanyan A
645 240 29 00	1.00	SFD	2	1.00	1.00	1.00	\$146.00	\$146.00	Rangel Jose&Veronica
645 240 30 00	1.00	SFD	2	1.00	1.00	1.00	\$146.00	\$146.00	Lewis Waldiemar&Una
645 240 31 00	1.00	SFD	2	1.00	1.00	1.00	\$146.00	\$146.00	Mollner Brian C&Susana A
645 240 32 00	1.00	SFD	2	1.00	1.00	1.00	\$146.00	\$146.00	Martinez Sergio&Cadena Veronica
645 240 33 00	1.00	SFD	2	1.00	1.00	1.00	\$146.00	\$146.00	Luat Family Trust 08-13-15 <Dva>
645 240 34 00	1.00	SFD	2	1.00	1.00	1.00	\$146.00	\$146.00	Carrasco Martin&Lucia A
645 240 35 00	1.00	SFD	2	1.00	1.00	1.00	\$146.00	\$146.00	Lov-Truong Family Trust 07-17-17
645 240 36 00	1.00	SFD	2	1.00	1.00	1.00	\$146.00	\$146.00	Ortega Gustavo&Martha C
645 240 37 00	1.00	SFD	2	1.00	1.00	1.00	\$146.00	\$146.00	Montero Alberto&Montero-Solis Mercedes V
645 240 38 00	1.00	SFD	2	1.00	1.00	1.00	\$146.00	\$146.00	Penn Elise D
645 240 39 00	1.00	SFD	2	1.00	1.00	1.00	\$146.00	\$146.00	Martinez Manuel J&Ramona
645 240 40 00	1.00	SFD	2	1.00	1.00	1.00	\$146.00	\$146.00	Mcgillivray Sean M&Lustina Marieta I
645 240 41 00	1.00	SFD	2	1.00	1.00	1.00	\$146.00	\$146.00	Rego Nadine L
645 240 42 00	1.00	SFD	2	1.00	1.00	1.00	\$146.00	\$146.00	Cline Michael&Bailey
645 240 43 00	1.00	SFD	2	1.00	1.00	1.00	\$146.00	\$146.00	Tan Edwin P&Annelyn G Revocable 2013 Trust 05-28-13

EXHIBIT C - Assessment Roll (Fiscal Year 2019)

Robinhood Ridge Maintenance Assessment District

Parcel Number	Acres/ Units ⁽¹⁾	Land Use ⁽²⁾	NW Otay Zone	Apportionment Factors		Total EBUs	Unit Cost (\$/Ebu)	FY 2019 ⁽⁴⁾ Assessment	Owner Name
				Land Use ⁽²⁾	Benefit ⁽³⁾				
645 240 44 00	1.00	SFD	2	1.00	1.00	1.00	\$146.00	\$146.00	Ferreira Adrian A&Jo A
645 240 45 00	1.00	SFD	2	1.00	1.00	1.00	\$146.00	\$146.00	Valles Jose L&Irene G
645 240 46 00	1.00	SFD	2	1.00	1.00	1.00	\$146.00	\$146.00	Vadakkumcherry Family Trust 02-10-12
645 240 47 00	1.00	SFD	2	1.00	1.00	1.00	\$146.00	\$146.00	Cruz Monica M
645 240 48 00	1.00	SFD	2	1.00	1.00	1.00	\$146.00	\$146.00	Sullivan Daniel L&Letecia B
645 240 49 00	1.00	SFD	2	1.00	1.00	1.00	\$146.00	\$146.00	Labor Lerida M
645 240 50 00	1.00	SFD	2	1.00	1.00	1.00	\$146.00	\$146.00	Pasion Lauro P
645 240 51 00	1.00	SFD	2	1.00	1.00	1.00	\$146.00	\$146.00	Conklin Terri L C
645 240 52 00	1.00	SFD	2	1.00	1.00	1.00	\$146.00	\$146.00	Rivera Abram&Rodriguez Paola J
645 240 53 00	1.00	SFD	2	1.00	1.00	1.00	\$146.00	\$146.00	Vo Dan A&Nhon T
645 240 54 00	1.00	SFD	2	1.00	1.00	1.00	\$146.00	\$146.00	Holdren Aaron&Shawnadee
645 240 55 00	1.00	SFD	2	1.00	1.00	1.00	\$146.00	\$146.00	Fields Steven M Jr&Kira K
645 240 56 00	1.00	SFD	2	1.00	1.00	1.00	\$146.00	\$146.00	Urbina Demosthenes Y Sr&Angelita T
645 240 57 00	1.00	SFD	2	1.00	1.00	1.00	\$146.00	\$146.00	Diaz-Curiel Alicia
645 240 58 00	1.00	SFD	2	1.00	1.00	1.00	\$146.00	\$146.00	Frausto Margarita Tr
645 241 01 00	1.00	SFD	2	1.00	1.00	1.00	\$146.00	\$146.00	Carter Gregory T Jr&Shakerra R
645 241 02 00	1.00	SFD	2	1.00	1.00	1.00	\$146.00	\$146.00	Rodriguez Rodrigo&Maria C
645 241 03 00	1.00	SFD	2	1.00	1.00	1.00	\$146.00	\$146.00	Garduno Maria G
645 241 04 00	1.00	SFD	2	1.00	1.00	1.00	\$146.00	\$146.00	Migliaccio Sean M&Myrna B
645 241 05 00	1.00	SFD	2	1.00	1.00	1.00	\$146.00	\$146.00	Webb Lucas M&Lestine C
645 241 06 00	1.00	SFD	2	1.00	1.00	1.00	\$146.00	\$146.00	Manichanh Jackson&Alyssa A
645 241 07 00	1.00	SFD	2	1.00	1.00	1.00	\$146.00	\$146.00	Pre Geoffrey G&Linda O
645 241 08 00	1.00	SFD	2	1.00	1.00	1.00	\$146.00	\$146.00	Lopez Ramiro&Demendez Maria L T
645 241 09 00	1.00	SFD	2	1.00	1.00	1.00	\$146.00	\$146.00	Shields Rodney&Rogayah
645 241 10 00	1.00	SFD	2	1.00	1.00	1.00	\$146.00	\$146.00	Rodriguez John D
645 241 11 00	1.00	SFD	2	1.00	1.00	1.00	\$146.00	\$146.00	Wise Gary&Gordon Emilyn
645 241 12 00	1.00	SFD	2	1.00	1.00	1.00	\$146.00	\$146.00	Serrano Family Trust 08-16-04
645 241 13 00	1.00	SFD	2	1.00	1.00	1.00	\$146.00	\$146.00	Estrella Family Trust 08-09-14
645 241 14 00	1.00	SFD	2	1.00	1.00	1.00	\$146.00	\$146.00	Szerlip Alexander&Crescentia
645 241 15 00	1.00	SFD	2	1.00	1.00	1.00	\$146.00	\$146.00	Aguilar Alejandro&Haydee R
645 241 16 00	1.00	SFD	2	1.00	1.00	1.00	\$146.00	\$146.00	Paniagua Cesar&Ana
645 241 17 00	1.00	SFD	2	1.00	1.00	1.00	\$146.00	\$146.00	Kong Candace Meewah
645 241 18 00	1.00	SFD	2	1.00	1.00	1.00	\$146.00	\$146.00	Biggs Guy&Ella Living Trust 01-29-11
645 241 19 00	1.00	SFD	2	1.00	1.00	1.00	\$146.00	\$146.00	Campbell Anthony E
645 241 20 00	1.00	SFD	2	1.00	1.00	1.00	\$146.00	\$146.00	Velarde Lucy E
645 241 21 00	1.00	SFD	2	1.00	1.00	1.00	\$146.00	\$146.00	Valdes Angel&Tesisteco Lourdes
645 241 22 00	1.00	SFD	2	1.00	1.00	1.00	\$146.00	\$146.00	Valles Christian A&Navarro Roberta G
645 241 23 00	1.00	SFD	2	1.00	1.00	1.00	\$146.00	\$146.00	Richardson Vanier C&Amber J
645 241 24 00	1.00	SFD	2	1.00	1.00	1.00	\$146.00	\$146.00	Lopez Miguel Jr&Vanessa M
645 241 25 00	1.00	SFD	2	1.00	1.00	1.00	\$146.00	\$146.00	Blazado Jason A&Joan M V
645 241 26 00	1.00	SFD	2	1.00	1.00	1.00	\$146.00	\$146.00	Halol Zalvador&Myra
645 241 27 00	1.00	SFD	2	1.00	1.00	1.00	\$146.00	\$146.00	Garcia Aaron O&Guadalupe
645 241 28 00	1.00	SFD	2	1.00	1.00	1.00	\$146.00	\$146.00	Ramos Ronnie&Nilanie
645 241 29 00	1.00	SFD	2	1.00	1.00	1.00	\$146.00	\$146.00	Carrillo Felipe&Olga Revocable 2011 Trust
645 241 30 00	1.00	SFD	2	1.00	1.00	1.00	\$146.00	\$146.00	Ruacho Brenna L
645 241 31 00	1.00	SFD	2	1.00	1.00	1.00	\$146.00	\$146.00	Senatin Arnel&Marivic
645 241 32 00	1.00	SFD	2	1.00	1.00	1.00	\$146.00	\$146.00	Sanchez Griselda V Separate Property Trust 04-13-06
645 241 33 00	1.00	SFD	2	1.00	1.00	1.00	\$146.00	\$146.00	Moss Steven C
645 241 34 00	1.00	SFD	2	1.00	1.00	1.00	\$146.00	\$146.00	Howard Samuel K&Cheryl K
645 241 35 00	1.00	SFD	2	1.00	1.00	1.00	\$146.00	\$146.00	Valle Elmer
645 241 36 00	1.00	SFD	2	1.00	1.00	1.00	\$146.00	\$146.00	Emperador Florencio M Jr&Rosa C
645 241 37 00	1.00	SFD	2	1.00	1.00	1.00	\$146.00	\$146.00	Moreno Marco A N
645 241 38 00	1.00	SFD	2	1.00	1.00	1.00	\$146.00	\$146.00	Hernandez Gilberto
645 241 39 00	1.00	SFD	2	1.00	1.00	1.00	\$146.00	\$146.00	Hernandez Fernando J&Maria L
645 241 40 00	1.00	SFD	2	1.00	1.00	1.00	\$146.00	\$146.00	Byrum Gregory D Revocable 2007 Trust 05-17-07
645 242 01 00	6.87	PKU	2	0.50	0.40	1.37	\$146.00	\$200.60	City Of San Diego
645 242 03 00	16.47	OSP	2	0.00	0.40	0.00	\$146.00	\$0.00	City Of San Diego
645 242 05 00	20.27	OSP	2	0.00	0.40	0.00	\$146.00	\$0.00	City Of San Diego
645 242 08 00	7.06	OSP	2	0.00	0.40	0.00	\$146.00	\$0.00	Edgewater At Vista Pacifica Homeowners Assn
645 242 09 01	1.00	CND	2	0.70	1.00	0.70	\$146.00	\$102.20	Oropeza Donato C&Natalia
645 242 09 02	1.00	CND	2	0.70	1.00	0.70	\$146.00	\$102.20	Barba Armando E Jr&Adan-Barba Sandra

EXHIBIT C - Assessment Roll (Fiscal Year 2019)

Robinhood Ridge Maintenance Assessment District

Parcel Number	Acres/ Units ⁽¹⁾	Land Use ⁽²⁾	NW Otay Zone	Apportionment Factors		Total EBUs	Unit Cost (\$/Ebu)	FY 2019 ⁽⁴⁾ Assessment	Owner Name
				Land Use ⁽²⁾	Benefit ⁽³⁾				
645 242 09 03	1.00	CND	2	0.70	1.00	0.70	\$146.00	\$102.20	Oropeza Jose C
645 242 09 04	1.00	CND	2	0.70	1.00	0.70	\$146.00	\$102.20	Sakkab Bassel H&Mervat
645 242 09 05	1.00	CND	2	0.70	1.00	0.70	\$146.00	\$102.20	Jackson Alexander L
645 242 09 06	1.00	CND	2	0.70	1.00	0.70	\$146.00	\$102.20	Bresser Douglas&Judith
645 242 11 01	1.00	CND	2	0.70	1.00	0.70	\$146.00	\$102.20	Leija Jasmine A
645 242 11 02	1.00	CND	2	0.70	1.00	0.70	\$146.00	\$102.20	Riveros Juan J
645 242 11 03	1.00	CND	2	0.70	1.00	0.70	\$146.00	\$102.20	Ibarra Rigoberto L
645 242 11 04	1.00	CND	2	0.70	1.00	0.70	\$146.00	\$102.20	Balderas Harissa
645 242 11 05	1.00	CND	2	0.70	1.00	0.70	\$146.00	\$102.20	Davis Siebie&Horne Dara A
645 242 11 06	1.00	CND	2	0.70	1.00	0.70	\$146.00	\$102.20	Gabryelski 2015 Family Trust
645 242 11 07	1.00	CND	2	0.70	1.00	0.70	\$146.00	\$102.20	Bevacqua Marcellino J
645 242 11 08	1.00	CND	2	0.70	1.00	0.70	\$146.00	\$102.20	Padilla Andres&Jacqueline
645 242 11 09	1.00	CND	2	0.70	1.00	0.70	\$146.00	\$102.20	Espinosa Walter&Sandra
645 242 11 10	1.00	CND	2	0.70	1.00	0.70	\$146.00	\$102.20	Ruvalcaba Arturo&Marquez Jessica
645 242 11 11	1.00	CND	2	0.70	1.00	0.70	\$146.00	\$102.20	Acosta Edmundo C&Hazel C
645 242 11 12	1.00	CND	2	0.70	1.00	0.70	\$146.00	\$102.20	Robinson Lillian P 2016 Revocable Trust 03-04-16
645 242 11 13	1.00	CND	2	0.70	1.00	0.70	\$146.00	\$102.20	Ramirez Wandy
645 242 11 14	1.00	CND	2	0.70	1.00	0.70	\$146.00	\$102.20	Gueta Isiah C&Alejandra
645 242 11 15	1.00	CND	2	0.70	1.00	0.70	\$146.00	\$102.20	Barbosa Javier&Maria E
645 242 11 16	1.00	CND	2	0.70	1.00	0.70	\$146.00	\$102.20	Montiel Armando F&Joy M
645 242 11 17	1.00	CND	2	0.70	1.00	0.70	\$146.00	\$102.20	Gonzali Gerardo&Janeth
645 242 11 18	1.00	CND	2	0.70	1.00	0.70	\$146.00	\$102.20	Escobar Alejandro C&Decardenas Rosa A C
645 242 12 01	1.00	CND	2	0.70	1.00	0.70	\$146.00	\$102.20	Bernache Alejandro&Juana
645 242 12 02	1.00	CND	2	0.70	1.00	0.70	\$146.00	\$102.20	Stewart Daniel P&Carmen L
645 242 12 03	1.00	CND	2	0.70	1.00	0.70	\$146.00	\$102.20	Camacho Maria D C
645 242 12 04	1.00	CND	2	0.70	1.00	0.70	\$146.00	\$102.20	Rubio Ezra S
645 242 12 05	1.00	CND	2	0.70	1.00	0.70	\$146.00	\$102.20	Vizcarra Noe G
645 242 12 06	1.00	CND	2	0.70	1.00	0.70	\$146.00	\$102.20	Reid Joshua&Maria
645 242 12 07	1.00	CND	2	0.70	1.00	0.70	\$146.00	\$102.20	Escamilla Fernando M
645 242 12 08	1.00	CND	2	0.70	1.00	0.70	\$146.00	\$102.20	Costello Ray H
645 242 12 09	1.00	CND	2	0.70	1.00	0.70	\$146.00	\$102.20	Miranda Jesus H&Monica
645 242 12 10	1.00	CND	2	0.70	1.00	0.70	\$146.00	\$102.20	Valencia Yamira
645 242 12 11	1.00	CND	2	0.70	1.00	0.70	\$146.00	\$102.20	Lopez Gerardo
645 242 12 12	1.00	CND	2	0.70	1.00	0.70	\$146.00	\$102.20	Tijam Patrick
645 242 12 13	1.00	CND	2	0.70	1.00	0.70	\$146.00	\$102.20	Arias Eduardo&Hernandez Sonia L
645 242 12 14	1.00	CND	2	0.70	1.00	0.70	\$146.00	\$102.20	Segura Family Trust 01-26-09
645 242 12 15	1.00	CND	2	0.70	1.00	0.70	\$146.00	\$102.20	Rodd Benjamin I&Alvarez Marisela M D C
645 242 12 16	1.00	CND	2	0.70	1.00	0.70	\$146.00	\$102.20	Campbell Juan E
645 242 12 17	1.00	CND	2	0.70	1.00	0.70	\$146.00	\$102.20	Cruz Henry
645 242 12 18	1.00	CND	2	0.70	1.00	0.70	\$146.00	\$102.20	Rochelle Family Trust 05-01-01
645 242 12 19	1.00	CND	2	0.70	1.00	0.70	\$146.00	\$102.20	Gutierrez Victor A
645 242 12 20	1.00	CND	2	0.70	1.00	0.70	\$146.00	\$102.20	Tucker Michael L&Deborah A
645 242 12 21	1.00	CND	2	0.70	1.00	0.70	\$146.00	\$102.20	Kim Kyungmin
645 242 12 22	1.00	CND	2	0.70	1.00	0.70	\$146.00	\$102.20	Krohn Joshua L
645 242 12 23	1.00	CND	2	0.70	1.00	0.70	\$146.00	\$102.20	Castellanos Alejandro&Elizabeth
645 242 12 24	1.00	CND	2	0.70	1.00	0.70	\$146.00	\$102.20	Cayabyab Dean D&Jasmine T
645 242 13 01	1.00	CND	2	0.70	1.00	0.70	\$146.00	\$102.20	Tiznado Bertha
645 242 13 02	1.00	CND	2	0.70	1.00	0.70	\$146.00	\$102.20	Aramburo Fidel C&Gonzalez Laura R
645 242 13 03	1.00	CND	2	0.70	1.00	0.70	\$146.00	\$102.20	Rodriguez Hector M
645 242 13 04	1.00	CND	2	0.70	1.00	0.70	\$146.00	\$102.20	Rieder Brianna
645 242 13 05	1.00	CND	2	0.70	1.00	0.70	\$146.00	\$102.20	Marquez Adiel&Denisse
645 242 13 06	1.00	CND	2	0.70	1.00	0.70	\$146.00	\$102.20	Ayala Conchita
645 242 13 07	1.00	CND	2	0.70	1.00	0.70	\$146.00	\$102.20	Luque Alfredo L
645 242 13 08	1.00	CND	2	0.70	1.00	0.70	\$146.00	\$102.20	Diaz Cynthia
645 242 13 09	1.00	CND	2	0.70	1.00	0.70	\$146.00	\$102.20	Flores Omar&Yolanda
645 242 13 10	1.00	CND	2	0.70	1.00	0.70	\$146.00	\$102.20	Lopezferrer Rafael A&Maria T
645 242 13 11	1.00	CND	2	0.70	1.00	0.70	\$146.00	\$102.20	Ascencio Roberto
645 242 13 12	1.00	CND	2	0.70	1.00	0.70	\$146.00	\$102.20	Ellis Christopher J&Lim Leakhena
645 242 13 13	1.00	CND	2	0.70	1.00	0.70	\$146.00	\$102.20	Romero Ernesto A
645 242 13 14	1.00	CND	2	0.70	1.00	0.70	\$146.00	\$102.20	Schmoker Isaac
645 242 13 15	1.00	CND	2	0.70	1.00	0.70	\$146.00	\$102.20	Kinchion Araceli

EXHIBIT C - Assessment Roll (Fiscal Year 2019)

Robinhood Ridge Maintenance Assessment District

Parcel Number	Acres/ Units ⁽¹⁾	Land Use ⁽²⁾	NW Otay Zone	Apportionment Factors		Total EBUs	Unit Cost (\$/Ebu)	FY 2019 ⁽⁴⁾ Assessment	Owner Name
				Land Use ⁽²⁾	Benefit ⁽³⁾				
645 242 13 16	1.00	CND	2	0.70	1.00	0.70	\$146.00	\$102.20	Bull Parris A
645 242 13 17	1.00	CND	2	0.70	1.00	0.70	\$146.00	\$102.20	Silva Daniel
645 242 13 18	1.00	CND	2	0.70	1.00	0.70	\$146.00	\$102.20	Lyle Steve
645 242 14 01	1.00	CND	2	0.70	1.00	0.70	\$146.00	\$102.20	Montoya Gladys G
645 242 14 02	1.00	CND	2	0.70	1.00	0.70	\$146.00	\$102.20	Farias Louis F&Salgado Yesenia V
645 242 14 03	1.00	CND	2	0.70	1.00	0.70	\$146.00	\$102.20	Morales Vivano R&Martha C
645 242 14 04	1.00	CND	2	0.70	1.00	0.70	\$146.00	\$102.20	Fonseca Jose R D&Estrada Lorena
645 242 14 05	1.00	CND	2	0.70	1.00	0.70	\$146.00	\$102.20	Real Alejandro
645 242 14 06	1.00	CND	2	0.70	1.00	0.70	\$146.00	\$102.20	Arevalo Alejandro
645 242 14 07	1.00	CND	2	0.70	1.00	0.70	\$146.00	\$102.20	Gonzalez Miguel Z&Leticia
645 242 14 08	1.00	CND	2	0.70	1.00	0.70	\$146.00	\$102.20	Zaratan Maricel R
645 242 14 09	1.00	CND	2	0.70	1.00	0.70	\$146.00	\$102.20	Pinzone Victor A&Jovana I
645 242 14 10	1.00	CND	2	0.70	1.00	0.70	\$146.00	\$102.20	Cruz-Medina Jorge
645 242 14 11	1.00	CND	2	0.70	1.00	0.70	\$146.00	\$102.20	Tiznado-Barragan Alberto
645 242 14 12	1.00	CND	2	0.70	1.00	0.70	\$146.00	\$102.20	Aguar David&Peiler Denise
645 242 14 13	1.00	CND	2	0.70	1.00	0.70	\$146.00	\$102.20	Munoz Margarita
645 242 14 14	1.00	CND	2	0.70	1.00	0.70	\$146.00	\$102.20	Talley Donald J lii&Yvonne G T
645 242 14 15	1.00	CND	2	0.70	1.00	0.70	\$146.00	\$102.20	Quiles Wendy R
645 242 14 16	1.00	CND	2	0.70	1.00	0.70	\$146.00	\$102.20	Asliazaran Mauricio&Esmerelda
645 242 14 17	1.00	CND	2	0.70	1.00	0.70	\$146.00	\$102.20	Tacardon Galen L B
645 242 14 18	1.00	CND	2	0.70	1.00	0.70	\$146.00	\$102.20	Lopez Sadi
645 242 15 01	1.00	CND	2	0.70	1.00	0.70	\$146.00	\$102.20	Bolds Derikka
645 242 15 02	1.00	CND	2	0.70	1.00	0.70	\$146.00	\$102.20	Velasco David Z&Zepeda Charlene
645 242 15 03	1.00	CND	2	0.70	1.00	0.70	\$146.00	\$102.20	Marsh Maria
645 242 15 04	1.00	CND	2	0.70	1.00	0.70	\$146.00	\$102.20	Florendo Abel C&Evelyn
645 242 15 05	1.00	CND	2	0.70	1.00	0.70	\$146.00	\$102.20	Lovato Marc L
645 242 15 06	1.00	CND	2	0.70	1.00	0.70	\$146.00	\$102.20	Guerrero Juan R&Rosalba
645 242 15 07	1.00	CND	2	0.70	1.00	0.70	\$146.00	\$102.20	Chaisongkram Family Trust 10-15-05
645 242 15 08	1.00	CND	2	0.70	1.00	0.70	\$146.00	\$102.20	Fejarang Earl
645 242 15 09	1.00	CND	2	0.70	1.00	0.70	\$146.00	\$102.20	Frey Matthew C
645 242 15 10	1.00	CND	2	0.70	1.00	0.70	\$146.00	\$102.20	Ciaccio Kenneth G
645 242 15 11	1.00	CND	2	0.70	1.00	0.70	\$146.00	\$102.20	Villegas Jose F&Gonzalez Laura E
645 242 15 12	1.00	CND	2	0.70	1.00	0.70	\$146.00	\$102.20	Montes Alberto I
645 242 15 13	1.00	CND	2	0.70	1.00	0.70	\$146.00	\$102.20	Barragan Jonathan&Macias Karen
645 242 15 14	1.00	CND	2	0.70	1.00	0.70	\$146.00	\$102.20	Camarena Reyes Jr
645 242 15 15	1.00	CND	2	0.70	1.00	0.70	\$146.00	\$102.20	Stevens James C&Ortiz-Stevens Yanira
645 242 15 16	1.00	CND	2	0.70	1.00	0.70	\$146.00	\$102.20	Zepeda Mariluz A
645 242 15 17	1.00	CND	2	0.70	1.00	0.70	\$146.00	\$102.20	Nolan Lindsey
645 242 15 18	1.00	CND	2	0.70	1.00	0.70	\$146.00	\$102.20	Argosino-Corazon Revocable Trust 01-14-14
645 242 16 01	1.00	CND	2	0.70	1.00	0.70	\$146.00	\$102.20	Sanchez Thomas Jr
645 242 16 02	1.00	CND	2	0.70	1.00	0.70	\$146.00	\$102.20	Paquian Christina
645 242 16 03	1.00	CND	2	0.70	1.00	0.70	\$146.00	\$102.20	Mancilla Sergio&Belinda D
645 242 16 04	1.00	CND	2	0.70	1.00	0.70	\$146.00	\$102.20	Marin Gabriel
645 242 16 05	1.00	CND	2	0.70	1.00	0.70	\$146.00	\$102.20	Rodriguez Lourdes K Trust 02-01-15
645 242 16 06	1.00	CND	2	0.70	1.00	0.70	\$146.00	\$102.20	Mclean Alistair S&Katy
645 242 16 07	1.00	CND	2	0.70	1.00	0.70	\$146.00	\$102.20	Maltman Scott E&Miriam C
645 242 16 08	1.00	CND	2	0.70	1.00	0.70	\$146.00	\$102.20	Saenz Samuel Jr&Kim
645 242 16 09	1.00	CND	2	0.70	1.00	0.70	\$146.00	\$102.20	Friestad Tyson J
645 242 16 10	1.00	CND	2	0.70	1.00	0.70	\$146.00	\$102.20	Gutierrez Hector A
645 242 16 11	1.00	CND	2	0.70	1.00	0.70	\$146.00	\$102.20	Metcalf Karlo S&Soria Perla
645 242 16 12	1.00	CND	2	0.70	1.00	0.70	\$146.00	\$102.20	Ramos Victor&Karla
645 242 16 13	1.00	CND	2	0.70	1.00	0.70	\$146.00	\$102.20	Zambrano Mario A
645 242 16 14	1.00	CND	2	0.70	1.00	0.70	\$146.00	\$102.20	Griffis Valerie R
645 242 16 15	1.00	CND	2	0.70	1.00	0.70	\$146.00	\$102.20	Bihouet Rafael&Delbosque Ariana J
645 242 16 16	1.00	CND	2	0.70	1.00	0.70	\$146.00	\$102.20	Batenga Kathleen
645 242 16 17	1.00	CND	2	0.70	1.00	0.70	\$146.00	\$102.20	Watson Larry C&Mamie M
645 242 16 18	1.00	CND	2	0.70	1.00	0.70	\$146.00	\$102.20	Ho Johnny K&Nguyen Jennifer N D
645 242 16 19	1.00	CND	2	0.70	1.00	0.70	\$146.00	\$102.20	Thomas Nolan
645 242 16 20	1.00	CND	2	0.70	1.00	0.70	\$146.00	\$102.20	Abencerraje Julio L Jr&Mar N
645 242 16 21	1.00	CND	2	0.70	1.00	0.70	\$146.00	\$102.20	Schaar Manuel E&Ema B O
645 242 16 22	1.00	CND	2	0.70	1.00	0.70	\$146.00	\$102.20	Gorman Douglas M&Borga Charlene

EXHIBIT C - Assessment Roll (Fiscal Year 2019)

Robinhood Ridge Maintenance Assessment District

Parcel Number	Acres/ Units ⁽¹⁾	Land Use ⁽²⁾	NW Otay Zone	Apportionment Factors		Total EBUS	Unit Cost (\$/EBU)	FY 2019 ⁽⁴⁾ Assessment	Owner Name
				Land Use ⁽²⁾	Benefit ⁽³⁾				
645 242 16 23	1.00	CND	2	0.70	1.00	0.70	\$146.00	\$102.20	Rodriguez Veronica F
645 242 16 24	1.00	CND	2	0.70	1.00	0.70	\$146.00	\$102.20	Basauri Maria L
645 250 01 00	1.00	SFD	2	1.00	1.00	1.00	\$146.00	\$146.00	Switzer Erick G&Karen S
645 250 02 00	1.00	SFD	2	1.00	1.00	1.00	\$146.00	\$146.00	Goodwin Tracy A&Rosanne
645 250 03 00	1.00	SFD	2	1.00	1.00	1.00	\$146.00	\$146.00	Lopez Lisa Revocable 2012 Trust
645 250 04 00	1.00	SFD	2	1.00	1.00	1.00	\$146.00	\$146.00	Lopez Ismael&Michel Serena N
645 250 05 00	1.00	SFD	2	1.00	1.00	1.00	\$146.00	\$146.00	Maheda Juan M
645 250 06 00	1.00	SFD	2	1.00	1.00	1.00	\$146.00	\$146.00	Rodriguez German&Angelica
645 250 07 00	1.00	SFD	2	1.00	1.00	1.00	\$146.00	\$146.00	Dieterle Joseph A&Monica
645 250 08 00	1.00	SFD	2	1.00	1.00	1.00	\$146.00	\$146.00	Rodriguez Moises
645 250 09 00	1.00	SFD	2	1.00	1.00	1.00	\$146.00	\$146.00	Antonio Francisco D&Maria E R
645 250 10 00	1.00	SFD	2	1.00	1.00	1.00	\$146.00	\$146.00	Garcia John C D L
645 250 11 00	1.00	SFD	2	1.00	1.00	1.00	\$146.00	\$146.00	Gadon Renante L&Ellen A
645 250 12 00	1.00	SFD	2	1.00	1.00	1.00	\$146.00	\$146.00	Rivera Francisco&Delfina
645 250 13 00	1.00	SFD	2	1.00	1.00	1.00	\$146.00	\$146.00	Valdez Efen&Gloria
645 250 14 00	1.00	SFD	2	1.00	1.00	1.00	\$146.00	\$146.00	Johnson Douglas W&Xu
645 250 15 00	1.00	SFD	2	1.00	1.00	1.00	\$146.00	\$146.00	Velazquez Carlos
645 250 16 00	1.00	SFD	2	1.00	1.00	1.00	\$146.00	\$146.00	Garcia Family Living Trust 02-25-15
645 250 17 00	1.00	SFD	2	1.00	1.00	1.00	\$146.00	\$146.00	Hendricks William L
645 250 18 00	1.00	SFD	2	1.00	1.00	1.00	\$146.00	\$146.00	Acevedo Octavio&Elvira
645 250 19 00	1.00	SFD	2	1.00	1.00	1.00	\$146.00	\$146.00	Romo Family Trust 09-09-03
645 250 20 00	1.00	SFD	2	1.00	1.00	1.00	\$146.00	\$146.00	Zacofsky Walter J Jr&Madelyn G
645 250 21 00	1.00	SFD	2	1.00	1.00	1.00	\$146.00	\$146.00	Lopez David
645 250 22 00	1.00	SFD	2	1.00	1.00	1.00	\$146.00	\$146.00	Hamawandi Bakir&Graciela
645 250 23 00	1.00	SFD	2	1.00	1.00	1.00	\$146.00	\$146.00	Bloom John B Iii
645 250 24 00	1.00	SFD	2	1.00	1.00	1.00	\$146.00	\$146.00	Sanchez Manuel
645 250 25 00	1.00	SFD	2	1.00	1.00	1.00	\$146.00	\$146.00	Vasquez Jorge C
645 250 26 00	1.00	SFD	2	1.00	1.00	1.00	\$146.00	\$146.00	Ortega Ricardo H&Monica
645 250 27 00	1.00	SFD	2	1.00	1.00	1.00	\$146.00	\$146.00	Miclat Annarita
645 250 28 00	1.00	SFD	2	1.00	1.00	1.00	\$146.00	\$146.00	Renick Carolyn J
645 250 29 00	1.00	SFD	2	1.00	1.00	1.00	\$146.00	\$146.00	Gage Robert&Quinlana-Gage Liliana
645 250 30 00	1.00	SFD	2	1.00	1.00	1.00	\$146.00	\$146.00	Corea German E
645 250 31 00	1.00	SFD	2	1.00	1.00	1.00	\$146.00	\$146.00	Mookini Christopher D&Dina J
645 250 32 00	1.00	SFD	2	1.00	1.00	1.00	\$146.00	\$146.00	Rotondo Eric R
645 250 33 00	1.00	SFD	2	1.00	1.00	1.00	\$146.00	\$146.00	Carranza Eddie&Iris
645 250 34 00	1.00	SFD	2	1.00	1.00	1.00	\$146.00	\$146.00	Ibarra Francisco J&Irma E
645 250 35 00	1.00	SFD	2	1.00	1.00	1.00	\$146.00	\$146.00	Woolton Family Trust 10-27-03
645 250 36 00	1.00	SFD	2	1.00	1.00	1.00	\$146.00	\$146.00	Perkins Detra L
645 250 37 00	1.00	SFD	2	1.00	1.00	1.00	\$146.00	\$146.00	Jimenez-Barrios Bettzi
645 250 38 00	1.00	SFD	2	1.00	1.00	1.00	\$146.00	\$146.00	Krause Eric P
645 250 39 00	1.00	SFD	2	1.00	1.00	1.00	\$146.00	\$146.00	Lopez Lawrence M&Elaine
645 250 40 00	1.00	SFD	2	1.00	1.00	1.00	\$146.00	\$146.00	Ronquillo Antonio P Jr&Carina C
645 250 41 00	1.00	SFD	2	1.00	1.00	1.00	\$146.00	\$146.00	Becerra Jesus L&Maria E
645 250 42 00	1.00	SFD	2	1.00	1.00	1.00	\$146.00	\$146.00	Rioveros Roderick Q Trust 06-14-07
645 250 43 00	1.00	SFD	2	1.00	1.00	1.00	\$146.00	\$146.00	Hernandez Hector S&Lorena
645 250 44 00	1.00	SFD	2	1.00	1.00	1.00	\$146.00	\$146.00	Ferrer Jacquelin R Living Trust 01-27-17
645 250 45 00	1.00	SFD	2	1.00	1.00	1.00	\$146.00	\$146.00	Morales Javier&Sandra I
645 250 46 00	1.00	SFD	2	1.00	1.00	1.00	\$146.00	\$146.00	Baltazar Juan F G
645 250 47 00	1.00	SFD	2	1.00	1.00	1.00	\$146.00	\$146.00	Gonzalez Ruperto F
645 250 48 00	1.00	SFD	2	1.00	1.00	1.00	\$146.00	\$146.00	Garrison Steven&Phan
645 250 49 00	1.00	SFD	2	1.00	1.00	1.00	\$146.00	\$146.00	Romero Edgar R&Patricia Y
645 250 50 00	1.00	SFD	2	1.00	1.00	1.00	\$146.00	\$146.00	Allen Family Trust 10-05-11
645 250 51 00	1.00	SFD	2	1.00	1.00	1.00	\$146.00	\$146.00	Redding Robert M Jr&Katherine M
645 250 52 00	1.00	SFD	2	1.00	1.00	1.00	\$146.00	\$146.00	Ruelas Edgar&Angel Mayra
645 250 53 00	1.00	SFD	2	1.00	1.00	1.00	\$146.00	\$146.00	Perez Gustavo&Claudia
645 250 54 00	1.00	SFD	2	1.00	1.00	1.00	\$146.00	\$146.00	Tomaroy William R&Raechelle H R
645 250 55 00	1.00	SFD	2	1.00	1.00	1.00	\$146.00	\$146.00	Gates Chad D
645 250 56 00	1.00	SFD	2	1.00	1.00	1.00	\$146.00	\$146.00	Inciong Tristan C&Michelle S
645 250 57 00	1.00	SFD	2	1.00	1.00	1.00	\$146.00	\$146.00	Balingit Giovanni D&Carmencita F
645 250 58 00	1.00	SFD	2	1.00	1.00	1.00	\$146.00	\$146.00	Rimorin Ronald L
645 250 59 00	1.00	SFD	2	1.00	1.00	1.00	\$146.00	\$146.00	Valdez Gerald Ii&Devaldez Milagros A L

EXHIBIT C - Assessment Roll (Fiscal Year 2019)

Robinhood Ridge Maintenance Assessment District

Parcel Number	Acres/ Units ⁽¹⁾	Land Use ⁽²⁾	NW Otay Zone	Apportionment Factors		Total EBUs	Unit Cost (\$/Ebu)	FY 2019 ⁽⁴⁾ Assessment	Owner Name
				Land Use ⁽²⁾	Benefit ⁽³⁾				
645 250 60 00	1.00	SFD	2	1.00	1.00	1.00	\$146.00	\$146.00	Fabela Dora P
645 250 61 00	1.00	SFD	2	1.00	1.00	1.00	\$146.00	\$146.00	Krokel Charles P Jr&Josephine
645 250 62 00	1.00	SFD	2	1.00	1.00	1.00	\$146.00	\$146.00	Lazarus Zachary T
645 250 63 00	1.00	SFD	2	1.00	1.00	1.00	\$146.00	\$146.00	Santana Maria
645 250 64 00	1.00	SFD	2	1.00	1.00	1.00	\$146.00	\$146.00	Monge Ricky V&Maricar D
645 250 65 00	1.00	SFD	2	1.00	1.00	1.00	\$146.00	\$146.00	Barizo Jerry C Jr&Evangeline
645 250 66 00	1.00	SFD	2	1.00	1.00	1.00	\$146.00	\$146.00	Manriquez Hector&Mayte W
645 250 67 00	1.00	SFD	2	1.00	1.00	1.00	\$146.00	\$146.00	Enano Alfredo C Jr&Sherry T
645 250 68 00	1.00	SFD	2	1.00	1.00	1.00	\$146.00	\$146.00	Godsey Dean C&Delia B
645 250 69 00	1.00	SFD	2	1.00	1.00	1.00	\$146.00	\$146.00	Ricalde Alfredo E&Norma P
645 250 70 00	1.00	SFD	2	1.00	1.00	1.00	\$146.00	\$146.00	Ceballos Janette C
645 250 71 00	1.00	SFD	2	1.00	1.00	1.00	\$146.00	\$146.00	Fuentecilla Merlina Living Trust 04-28-06
645 250 72 00	1.00	SFD	2	1.00	1.00	1.00	\$146.00	\$146.00	Paniagua Saul&Laura R
645 250 73 00	1.00	SFD	2	1.00	1.00	1.00	\$146.00	\$146.00	Gochicoa Eugene M
645 250 74 00	1.00	SFD	2	1.00	1.00	1.00	\$146.00	\$146.00	Green Robert Jr&Jennifer
645 250 75 00	1.00	SFD	2	1.00	1.00	1.00	\$146.00	\$146.00	Montayre Philippe&Hanna
645 250 76 00	1.00	SFD	2	1.00	1.00	1.00	\$146.00	\$146.00	Garcia Gabriel&Andrea L
645 250 77 00	1.00	SFD	2	1.00	1.00	1.00	\$146.00	\$146.00	Miranda Eduardo V&Yanin
645 250 78 00	1.00	SFD	2	1.00	1.00	1.00	\$146.00	\$146.00	Serns William F&Maria M
645 250 79 00	1.00	SFD	2	1.00	1.00	1.00	\$146.00	\$146.00	Taylor Wesley
645 250 80 00	1.00	SFD	2	1.00	1.00	1.00	\$146.00	\$146.00	Arredondo Salomon C
645 250 81 00	1.00	SFD	2	1.00	1.00	1.00	\$146.00	\$146.00	Bosset Steven S Jr&Deborah M
645 250 82 00	1.00	SFD	2	1.00	1.00	1.00	\$146.00	\$146.00	Lopez Enrique
645 250 83 00	1.00	SFD	2	1.00	1.00	1.00	\$146.00	\$146.00	Decastro Ronald C
645 251 01 00	1.00	SFD	2	1.00	1.00	1.00	\$146.00	\$146.00	Martinez Javier
645 251 02 00	1.00	SFD	2	1.00	1.00	1.00	\$146.00	\$146.00	Santos-Gebremariam Marise C
645 251 03 00	1.00	SFD	2	1.00	1.00	1.00	\$146.00	\$146.00	Livingston Brett&Benko-Livingston Dody
645 251 04 00	1.00	SFD	2	1.00	1.00	1.00	\$146.00	\$146.00	Araos Ricardo A
645 251 05 00	1.00	SFD	2	1.00	1.00	1.00	\$146.00	\$146.00	Jackson Laurie A
645 251 06 00	1.00	SFD	2	1.00	1.00	1.00	\$146.00	\$146.00	Shimbori Takao&Truong Phaly My
645 251 07 00	1.00	SFD	2	1.00	1.00	1.00	\$146.00	\$146.00	Williams Victor A
645 251 08 00	1.00	SFD	2	1.00	1.00	1.00	\$146.00	\$146.00	Munoz Juan&Alba-Munoz Karla
645 251 09 00	1.00	SFD	2	1.00	1.00	1.00	\$146.00	\$146.00	Cunanan Gener P&Gilda B
645 251 10 00	1.00	SFD	2	1.00	1.00	1.00	\$146.00	\$146.00	Camacho Adrian
645 251 11 00	1.00	SFD	2	1.00	1.00	1.00	\$146.00	\$146.00	Cruz Cole
645 251 12 00	1.00	SFD	2	1.00	1.00	1.00	\$146.00	\$146.00	Cruz-Ruiz Maria G
645 251 13 00	1.00	SFD	2	1.00	1.00	1.00	\$146.00	\$146.00	Yao William&Wang Zhenling
645 251 14 00	1.00	SFD	2	1.00	1.00	1.00	\$146.00	\$146.00	Mercer Ottley W&Delma F 2015 Revocable Trust
645 251 15 00	1.00	SFD	2	1.00	1.00	1.00	\$146.00	\$146.00	Douglas Mario X&Laura M
645 251 16 00	1.00	SFD	2	1.00	1.00	1.00	\$146.00	\$146.00	Dillman William E Jr&Luisa
645 252 01 00	1.00	SFD	2	1.00	1.00	1.00	\$146.00	\$146.00	Hogan Michael J&Ning Grace J
645 252 02 00	1.00	SFD	2	1.00	1.00	1.00	\$146.00	\$146.00	Castro Ricardo
645 252 03 00	1.00	SFD	2	1.00	1.00	1.00	\$146.00	\$146.00	Portillo Carlos&Murillo Juana
645 252 04 00	1.00	SFD	2	1.00	1.00	1.00	\$146.00	\$146.00	Salcedo Bertha
645 252 05 00	1.00	SFD	2	1.00	1.00	1.00	\$146.00	\$146.00	David Pablito P&Bonita L
645 252 06 00	1.00	SFD	2	1.00	1.00	1.00	\$146.00	\$146.00	Leal Jesus A V&Valenzuela Maria D R S D
645 252 07 00	1.00	SFD	2	1.00	1.00	1.00	\$146.00	\$146.00	Bustillos Omar&Renova Jeanette
645 252 08 00	1.00	SFD	2	1.00	1.00	1.00	\$146.00	\$146.00	Gomez Adriana
645 252 09 00	1.00	SFD	2	1.00	1.00	1.00	\$146.00	\$146.00	Montenegro Jesus R&Consolacion M
645 252 10 00	1.00	SFD	2	1.00	1.00	1.00	\$146.00	\$146.00	Edwards David&Carmen
645 252 11 00	1.00	SFD	2	1.00	1.00	1.00	\$146.00	\$146.00	Montiel Ismael&Patricia
645 252 12 00	1.00	SFD	2	1.00	1.00	1.00	\$146.00	\$146.00	Gallegos Luis E G&Cano Shaarabel
645 252 13 00	1.00	SFD	2	1.00	1.00	1.00	\$146.00	\$146.00	Frazao Louis F
645 252 14 00	1.00	SFD	2	1.00	1.00	1.00	\$146.00	\$146.00	Avila J Jesus O&Orendain Josefina C D
645 252 15 00	1.00	SFD	2	1.00	1.00	1.00	\$146.00	\$146.00	Chavira Jose P&Silvia G Revocable Family 2001 Trust
645 252 16 00	1.00	SFD	2	1.00	1.00	1.00	\$146.00	\$146.00	Poserio Arnulfo F&Jemuelle A
645 252 17 00	1.00	SFD	2	1.00	1.00	1.00	\$146.00	\$146.00	Grockowski Family Trust 07-28-10
645 252 18 00	1.00	SFD	2	1.00	1.00	1.00	\$146.00	\$146.00	Broadnax Mecca A
645 252 19 00	1.00	SFD	2	1.00	1.00	1.00	\$146.00	\$146.00	Hernandez Francisco&Soledad
645 252 20 00	1.00	SFD	2	1.00	1.00	1.00	\$146.00	\$146.00	Conner Charles E&Jessi
645 252 21 00	1.00	SFD	2	1.00	1.00	1.00	\$146.00	\$146.00	Alvarez-Boone Rebecca D

EXHIBIT C - Assessment Roll (Fiscal Year 2019)

Robinhood Ridge Maintenance Assessment District

Parcel Number	Acres/ Units ⁽¹⁾	Land Use ⁽²⁾	NW Otay Zone	Apportionment Factors		Total EBUS	Unit Cost (\$/EBU)	FY 2019 ⁽⁴⁾ Assessment	Owner Name
				Land Use ⁽²⁾	Benefit ⁽³⁾				
645 252 22 00	1.00	SFD	2	1.00	1.00	1.00	\$146.00	\$146.00	Uribe Javier F
645 252 23 00	1.00	SFD	2	1.00	1.00	1.00	\$146.00	\$146.00	Lehpamer Hrvoj
645 252 24 00	1.00	SFD	2	1.00	1.00	1.00	\$146.00	\$146.00	Riley Jason P&Clarissa E
645 252 25 00	1.00	SFD	2	1.00	1.00	1.00	\$146.00	\$146.00	Jackson Marcus A Jr&Deatrice R
645 252 26 00	1.00	SFD	2	1.00	1.00	1.00	\$146.00	\$146.00	Pina Eduardo&Melina
645 252 27 00	1.00	SFD	2	1.00	1.00	1.00	\$146.00	\$146.00	Catalano Christopher J&Pulvino Deeann V
645 252 28 00	1.00	SFD	2	1.00	1.00	1.00	\$146.00	\$146.00	Kennerly Traci L
645 252 29 00	1.00	SFD	2	1.00	1.00	1.00	\$146.00	\$146.00	Vinuya Joseph V&Dotimas Magdalena B
645 252 30 00	1.00	SFD	2	1.00	1.00	1.00	\$146.00	\$146.00	Idosor Rhodora
645 252 31 00	1.00	SFD	2	1.00	1.00	1.00	\$146.00	\$146.00	Garcia Oscar C M&Martinez Nancy
645 252 32 00	1.00	SFD	2	1.00	1.00	1.00	\$146.00	\$146.00	Zafico Family Trust 10-31-16
645 252 33 00	1.00	SFD	2	1.00	1.00	1.00	\$146.00	\$146.00	Angeles Frolan&Sheila
645 252 34 00	1.00	SFD	2	1.00	1.00	1.00	\$146.00	\$146.00	Gonzalez John M&Maria L
645 252 35 00	1.00	SFD	2	1.00	1.00	1.00	\$146.00	\$146.00	Leblanc Christopher L&Martha P
645 252 36 00	1.00	SFD	2	1.00	1.00	1.00	\$146.00	\$146.00	Mixco Hugo&Teresa
645 252 37 00	1.00	SFD	2	1.00	1.00	1.00	\$146.00	\$146.00	Dizon Januario T&Laura T
645 252 38 00	1.00	SFD	2	1.00	1.00	1.00	\$146.00	\$146.00	Yamamoto Julieann S
645 252 39 00	1.00	SFD	2	1.00	1.00	1.00	\$146.00	\$146.00	Fowler Shawn&Aldaco Nora
645 252 40 00	1.00	SFD	2	1.00	1.00	1.00	\$146.00	\$146.00	Delacruz Danilo&Ermelinda
645 252 41 00	1.00	SFD	2	1.00	1.00	1.00	\$146.00	\$146.00	Barnes Erick&Monique
645 252 42 00	1.00	SFD	2	1.00	1.00	1.00	\$146.00	\$146.00	Ayala Irving E&Vega Araceli
645 252 43 00	1.00	SFD	2	1.00	1.00	1.00	\$146.00	\$146.00	Ibarra Guillermo L&Teresa
645 252 44 00	1.00	SFD	2	1.00	1.00	1.00	\$146.00	\$146.00	Perez Junel&Argeline
645 252 45 00	1.00	SFD	2	1.00	1.00	1.00	\$146.00	\$146.00	Porras Enrique M Ili&Martha
645 252 46 00	1.00	SFD	2	1.00	1.00	1.00	\$146.00	\$146.00	Bock John A&Viola T
645 252 47 00	1.00	SFD	2	1.00	1.00	1.00	\$146.00	\$146.00	Perez Living Trust 07-14-09
645 252 48 00	1.00	SFD	2	1.00	1.00	1.00	\$146.00	\$146.00	Noriega Maria D L A
645 252 49 00	1.00	SFD	2	1.00	1.00	1.00	\$146.00	\$146.00	Armenta Jose A&Blanca E
645 252 50 00	1.00	SFD	2	1.00	1.00	1.00	\$146.00	\$146.00	Tames Luciano&Julie I G
645 252 51 00	1.00	SFD	2	1.00	1.00	1.00	\$146.00	\$146.00	Barrett Mark W
645 252 52 00	1.00	SFD	2	1.00	1.00	1.00	\$146.00	\$146.00	Arndt Christopher&Hennessey Hang N
645 252 53 00	1.00	SFD	2	1.00	1.00	1.00	\$146.00	\$146.00	Bautista Ferdinand&Michelin D R
645 252 54 00	1.00	SFD	2	1.00	1.00	1.00	\$146.00	\$146.00	Jurado Francisco
645 252 55 00	1.00	SFD	2	1.00	1.00	1.00	\$146.00	\$146.00	Banares Arlene B&Larry D
645 252 56 00	1.00	SFD	2	1.00	1.00	1.00	\$146.00	\$146.00	Korchnoy Yuliy
645 252 57 00	1.00	SFD	2	1.00	1.00	1.00	\$146.00	\$146.00	Valencia Carlos&Ruby Family Trust 04-18-14
645 252 58 00	1.00	SFD	2	1.00	1.00	1.00	\$146.00	\$146.00	Salazar Lourdes M
645 252 59 00	1.00	SFD	2	1.00	1.00	1.00	\$146.00	\$146.00	Santos Raymond&Wilma
645 252 60 00	1.00	SFD	2	1.00	1.00	1.00	\$146.00	\$146.00	Apostol Family Trust 02-26-01
645 252 61 00	1.00	SFD	2	1.00	1.00	1.00	\$146.00	\$146.00	Fialkowski Edward&Aida A L Family Trust 02-06-04
645 252 62 00	1.00	SFD	2	1.00	1.00	1.00	\$146.00	\$146.00	Chalupnik Jerry M Dds Living Trust 06-12-17
645 252 63 00	1.00	SFD	2	1.00	1.00	1.00	\$146.00	\$146.00	Parda Family Trust
645 252 64 00	1.00	SFD	2	1.00	1.00	1.00	\$146.00	\$146.00	Vanmartin Reginald&Ahlin Pia T
645 252 65 00	1.00	SFD	2	1.00	1.00	1.00	\$146.00	\$146.00	Somera Laurence&Maria M V
645 252 66 00	1.00	SFD	2	1.00	1.00	1.00	\$146.00	\$146.00	Bruton Leaman&Sabina
645 252 67 00	1.00	SFD	2	1.00	1.00	1.00	\$146.00	\$146.00	Holt John&Veronica E
645 252 68 00	1.00	SFD	2	1.00	1.00	1.00	\$146.00	\$146.00	Schlais Kyle
645 252 69 00	1.06	OSP	2	0.00	0.40	0.00	\$146.00	\$0.00	City Of San Diego
645 253 01 00	1.00	SFD	2	1.00	1.00	1.00	\$146.00	\$146.00	Gutierrez Juan C&Delene
645 253 02 00	1.00	SFD	2	1.00	1.00	1.00	\$146.00	\$146.00	Swier Robert J&Diane
645 253 03 00	1.00	SFD	2	1.00	1.00	1.00	\$146.00	\$146.00	Bush Nerolee
645 253 04 00	1.00	SFD	2	1.00	1.00	1.00	\$146.00	\$146.00	Gavino Family Trust 09-04-97
645 253 05 00	1.00	SFD	2	1.00	1.00	1.00	\$146.00	\$146.00	Apostol Family Trust 02-26-01
645 253 06 00	1.00	SFD	2	1.00	1.00	1.00	\$146.00	\$146.00	Pacheco Eugenia
645 253 07 00	1.00	SFD	2	1.00	1.00	1.00	\$146.00	\$146.00	Castro Gabriel J&Ofelia
645 253 08 00	1.00	SFD	2	1.00	1.00	1.00	\$146.00	\$146.00	Smith David B
645 253 09 00	1.00	SFD	2	1.00	1.00	1.00	\$146.00	\$146.00	Sandoval Daniel J(Dp)
645 253 10 00	1.00	SFD	2	1.00	1.00	1.00	\$146.00	\$146.00	Dolcini-Camacho Family Trust 06-30-16
645 253 11 00	1.00	SFD	2	1.00	1.00	1.00	\$146.00	\$146.00	Hauer John G
645 253 12 00	1.00	SFD	2	1.00	1.00	1.00	\$146.00	\$146.00	Wootton Family Trust 10-27-03
645 253 13 00	1.00	SFD	2	1.00	1.00	1.00	\$146.00	\$146.00	Castellanos Marisol

EXHIBIT C - Assessment Roll (Fiscal Year 2019)

Robinhood Ridge Maintenance Assessment District

Parcel Number	Acres/ Units ⁽¹⁾	Land Use ⁽²⁾	NW Otay Zone	Apportionment Factors		Total EBUS	Unit Cost (\$/EBU)	FY 2019 ⁽⁴⁾ Assessment	Owner Name
				Land Use ⁽²⁾	Benefit ⁽³⁾				
645 253 14 00	1.00	SFD	2	1.00	1.00	1.00	\$146.00	\$146.00	Mangayat Oscar D&Maryludy D
645 253 15 00	1.00	SFD	2	1.00	1.00	1.00	\$146.00	\$146.00	Pansacula Doroteo C&Teresita L
645 253 16 00	1.00	SFD	2	1.00	1.00	1.00	\$146.00	\$146.00	Kinsey Daniel S&Russell-Kinsey Amy J
645 253 17 00	1.00	SFD	2	1.00	1.00	1.00	\$146.00	\$146.00	Molina Raul F&Figuroa Nora E
645 253 18 00	6.61	OSP	2	0.00	0.40	0.00	\$146.00	\$0.00	City Of San Diego
645 260 01 00	1.00	SFD	2	1.00	1.00	1.00	\$146.00	\$146.00	Tomma Magid E&Laura
645 260 02 00	1.00	SFD	2	1.00	1.00	1.00	\$146.00	\$146.00	Arguilez Dion&Aethea M
645 260 03 00	1.00	SFD	2	1.00	1.00	1.00	\$146.00	\$146.00	Aguirre Lucio&Lucia N
645 260 04 00	1.00	SFD	2	1.00	1.00	1.00	\$146.00	\$146.00	Mercado Henry&Denise
645 260 05 00	1.00	SFD	2	1.00	1.00	1.00	\$146.00	\$146.00	Steele Jacob R&Cynthia
645 260 06 00	1.00	SFD	2	1.00	1.00	1.00	\$146.00	\$146.00	Babida Michael&Sietske C
645 260 07 00	1.00	SFD	2	1.00	1.00	1.00	\$146.00	\$146.00	Bernal Jose A&Anakaren
645 260 08 00	1.00	SFD	2	1.00	1.00	1.00	\$146.00	\$146.00	Lutu Faamalo&Barbara M
645 260 09 00	1.00	SFD	2	1.00	1.00	1.00	\$146.00	\$146.00	Garcia Mark L C&Jean A E
645 260 10 00	1.00	SFD	2	1.00	1.00	1.00	\$146.00	\$146.00	Luongo Christopher&Jessica
645 260 11 00	1.00	SFD	2	1.00	1.00	1.00	\$146.00	\$146.00	Flores Jorge A&Perla R
645 260 12 00	1.00	SFD	2	1.00	1.00	1.00	\$146.00	\$146.00	Mcgregor Michael
645 260 13 00	1.00	SFD	2	1.00	1.00	1.00	\$146.00	\$146.00	Delacruz Raul U&Caroline B C
645 260 14 00	1.00	SFD	2	1.00	1.00	1.00	\$146.00	\$146.00	Barrios Diana Y
645 260 15 00	1.00	SFD	2	1.00	1.00	1.00	\$146.00	\$146.00	Gergurich Michelle C
645 260 16 00	1.00	SFD	2	1.00	1.00	1.00	\$146.00	\$146.00	Brantley Eglantina
645 260 17 00	1.00	SFD	2	1.00	1.00	1.00	\$146.00	\$146.00	Rodolfa Jacqueline E
645 260 18 00	1.00	SFD	2	1.00	1.00	1.00	\$146.00	\$146.00	Sanchez Hector&Lottie I W
645 260 19 00	1.00	SFD	2	1.00	1.00	1.00	\$146.00	\$146.00	Garrido Miguel A&Louisa J
645 260 20 00	1.00	SFD	2	1.00	1.00	1.00	\$146.00	\$146.00	Bartone Douglas li&Kelsey
645 260 21 00	1.00	SFD	2	1.00	1.00	1.00	\$146.00	\$146.00	Salgado Don
645 260 22 00	1.00	SFD	2	1.00	1.00	1.00	\$146.00	\$146.00	Andino Ricardo J&Marianne S
645 260 23 00	1.00	SFD	2	1.00	1.00	1.00	\$146.00	\$146.00	Nunez Jack R Estate Of
645 260 24 00	1.00	SFD	2	1.00	1.00	1.00	\$146.00	\$146.00	Gannon Mark S
645 260 25 00	1.00	SFD	2	1.00	1.00	1.00	\$146.00	\$146.00	Dennis Ronald M&Lesley D
645 260 26 00	1.00	SFD	2	1.00	1.00	1.00	\$146.00	\$146.00	Alvarado Brandon&Krystal
645 260 27 00	1.00	SFD	2	1.00	1.00	1.00	\$146.00	\$146.00	Pizarro Family Trust 09-07-10
645 260 28 00	1.00	SFD	2	1.00	1.00	1.00	\$146.00	\$146.00	Sierra Ramiro
645 260 29 00	1.00	SFD	2	1.00	1.00	1.00	\$146.00	\$146.00	Michel Abraham M&Martha S
645 260 30 00	1.00	SFD	2	1.00	1.00	1.00	\$146.00	\$146.00	Escano Arnold T&Jennifer S
645 260 31 00	1.00	SFD	2	1.00	1.00	1.00	\$146.00	\$146.00	Hernandez Alejandro M&Estrada Lucinda
645 260 32 00	1.00	SFD	2	1.00	1.00	1.00	\$146.00	\$146.00	Gonzalez Silvia
645 260 33 00	1.00	SFD	2	1.00	1.00	1.00	\$146.00	\$146.00	Navarro Ramon&Angelica
645 260 34 00	1.00	SFD	2	1.00	1.00	1.00	\$146.00	\$146.00	Mcgann Family Trust 06-06-11
645 260 35 00	1.00	SFD	2	1.00	1.00	1.00	\$146.00	\$146.00	Sitson Nestor Y&Gloria M
645 260 36 00	1.00	SFD	2	1.00	1.00	1.00	\$146.00	\$146.00	Olvera Jesus&Claudia J
645 260 37 00	1.00	SFD	2	1.00	1.00	1.00	\$146.00	\$146.00	Rasmussen Susan L
645 260 38 00	1.00	SFD	2	1.00	1.00	1.00	\$146.00	\$146.00	Lopez Hugo S
645 260 39 00	1.00	SFD	2	1.00	1.00	1.00	\$146.00	\$146.00	Atondo Daniel P&Portillo Cesla A
645 260 40 00	1.00	SFD	2	1.00	1.00	1.00	\$146.00	\$146.00	Manglicmot Dennis&Amalia
645 260 41 00	1.00	SFD	2	1.00	1.00	1.00	\$146.00	\$146.00	Domingo Amy C
645 260 42 00	1.00	SFD	2	1.00	1.00	1.00	\$146.00	\$146.00	Rojas Ricardo&Summer
645 260 43 00	1.00	SFD	2	1.00	1.00	1.00	\$146.00	\$146.00	Gomez Roberto R&Ofelia V
645 260 44 00	1.00	SFD	2	1.00	1.00	1.00	\$146.00	\$146.00	Love Donald&Jocelyn V
645 260 46 00	1.00	SFD	2	1.00	1.00	1.00	\$146.00	\$146.00	Lara Rigoberto Jr&Michelle Revocable 2016 Trust 06-29-1
645 260 47 00	1.00	SFD	2	1.00	1.00	1.00	\$146.00	\$146.00	Jochimsen Aaron A
645 260 48 00	1.00	SFD	2	1.00	1.00	1.00	\$146.00	\$146.00	Hindman Donald J&Eileen C
645 260 49 00	1.00	SFD	2	1.00	1.00	1.00	\$146.00	\$146.00	Brathwaite Darrell R&Karla B
645 260 50 00	1.00	SFD	2	1.00	1.00	1.00	\$146.00	\$146.00	Thomas Donn H Revocable Trust 01-13-17
645 260 51 00	1.00	SFD	2	1.00	1.00	1.00	\$146.00	\$146.00	Chua Daniel B&Eleanor E
645 260 52 00	1.00	SFD	2	1.00	1.00	1.00	\$146.00	\$146.00	Harbin Levi&Melissa Living Trust 11-06-15
645 260 53 00	1.00	SFD	2	1.00	1.00	1.00	\$146.00	\$146.00	Cole Oran S&Yeager Ruff B li
645 260 54 00	1.00	SFD	2	1.00	1.00	1.00	\$146.00	\$146.00	Rubi Ricardo&Yannet
645 260 55 00	1.00	SFD	2	1.00	1.00	1.00	\$146.00	\$146.00	Ambrose Luigi E&Ambay Lula A
645 260 56 00	1.00	SFD	2	1.00	1.00	1.00	\$146.00	\$146.00	Phan Christian&Diana
645 260 57 00	1.00	SFD	2	1.00	1.00	1.00	\$146.00	\$146.00	Aliping Bob M&Jacelyn T

EXHIBIT C - Assessment Roll (Fiscal Year 2019)

Robinhood Ridge Maintenance Assessment District

Parcel Number	Acres/ Units ⁽¹⁾	Land Use ⁽²⁾	NW Otay Zone	Apportionment Factors		Total EBUS	Unit Cost (\$/EBU)	FY 2019 ⁽⁴⁾ Assessment	Owner Name
				Land Use ⁽²⁾	Benefit ⁽³⁾				
645 260 58 00	1.00	SFD	2	1.00	1.00	1.00	\$146.00	\$146.00	Coronado Ernesto
645 260 59 00	1.00	SFD	2	1.00	1.00	1.00	\$146.00	\$146.00	Satrom Scott T
645 261 01 00	1.00	SFD	2	1.00	1.00	1.00	\$146.00	\$146.00	Prian Marisela
645 261 02 00	1.00	SFD	2	1.00	1.00	1.00	\$146.00	\$146.00	Stockwell Chris&Amanda
645 261 03 00	1.00	SFD	2	1.00	1.00	1.00	\$146.00	\$146.00	Madueno Marco A
645 261 04 00	1.00	SFD	2	1.00	1.00	1.00	\$146.00	\$146.00	Valverde Nydia M Revocable 2008 Trust
645 261 05 00	1.00	SFD	2	1.00	1.00	1.00	\$146.00	\$146.00	Zuniga David
645 261 06 00	1.00	SFD	2	1.00	1.00	1.00	\$146.00	\$146.00	Gutierrez Fabian
645 261 07 00	1.00	SFD	2	1.00	1.00	1.00	\$146.00	\$146.00	Perez Matthew&Simone
645 261 08 00	1.00	SFD	2	1.00	1.00	1.00	\$146.00	\$146.00	Mangat Lamberto A&Lolita S <Dd>
645 261 09 00	1.00	SFD	2	1.00	1.00	1.00	\$146.00	\$146.00	Sanchez Omar
645 261 10 00	1.00	SFD	2	1.00	1.00	1.00	\$146.00	\$146.00	Guerrero Jose H&Yvonne
645 261 11 00	1.00	SFD	2	1.00	1.00	1.00	\$146.00	\$146.00	Swanson Michael
645 261 12 00	1.00	SFD	2	1.00	1.00	1.00	\$146.00	\$146.00	Delgado Angel L Jr&Daisey P
645 261 13 00	1.00	SFD	2	1.00	1.00	1.00	\$146.00	\$146.00	Navarro Andrei M&Javier Aileen R
645 261 14 00	1.00	SFD	2	1.00	1.00	1.00	\$146.00	\$146.00	Mendiara Chris&Scolari Rosana
645 261 15 00	1.00	SFD	2	1.00	1.00	1.00	\$146.00	\$146.00	Montiel Ramon B&Concepcion J
645 261 16 00	1.00	SFD	2	1.00	1.00	1.00	\$146.00	\$146.00	Liwanag Rafael G&Lorina M
645 261 17 00	1.00	SFD	2	1.00	1.00	1.00	\$146.00	\$146.00	Phillips Kenneth J&Laiti Amal
645 261 18 00	1.00	SFD	2	1.00	1.00	1.00	\$146.00	\$146.00	Casillas Carlos G&Marroquin Diala
645 261 19 00	1.00	SFD	2	1.00	1.00	1.00	\$146.00	\$146.00	Wells Jason M
645 261 20 00	1.00	SFD	2	1.00	1.00	1.00	\$146.00	\$146.00	Cruz Dominic T&Natalie S
645 261 21 00	1.00	SFD	2	1.00	1.00	1.00	\$146.00	\$146.00	Pecjo Roberto M&Carlota P
645 261 22 00	1.00	SFD	2	1.00	1.00	1.00	\$146.00	\$146.00	Bruyere Cameron P&Civil-Bruyere Laurence A
645 261 25 00	1.00	SFD	2	1.00	1.00	1.00	\$146.00	\$146.00	Derby David P&Antoinette M
645 261 26 00	1.00	SFD	2	1.00	1.00	1.00	\$146.00	\$146.00	Ling Jeanne Y
645 261 27 00	1.00	SFD	2	1.00	1.00	1.00	\$146.00	\$146.00	West Gregru T&Queenie G
645 261 28 00	1.00	SFD	2	1.00	1.00	1.00	\$146.00	\$146.00	Rangel Jaime E&Delia
645 261 29 00	1.00	SFD	2	1.00	1.00	1.00	\$146.00	\$146.00	Romero Ricardo E&Danielle E
645 261 30 00	1.00	SFD	2	1.00	1.00	1.00	\$146.00	\$146.00	Vu Family Trust 01-16-06
645 261 31 00	1.00	SFD	2	1.00	1.00	1.00	\$146.00	\$146.00	Sahic Damir&Vernesa
645 261 32 00	1.00	SFD	2	1.00	1.00	1.00	\$146.00	\$146.00	Brown Vance G
645 261 33 00	1.00	SFD	2	1.00	1.00	1.00	\$146.00	\$146.00	Villarreal Jose L&Adrianna
645 261 34 00	1.00	SFD	2	1.00	1.00	1.00	\$146.00	\$146.00	Silva Jesus M&Guadalupe
645 261 35 00	1.00	SFD	2	1.00	1.00	1.00	\$146.00	\$146.00	Yoshida Hayato&Michelle
645 261 36 00	1.00	SFD	2	1.00	1.00	1.00	\$146.00	\$146.00	Alvarez Luis&Zavala Maria M
645 261 37 00	1.00	SFD	2	1.00	1.00	1.00	\$146.00	\$146.00	Valdez Efen&Gloria M
645 261 38 00	1.00	SFD	2	1.00	1.00	1.00	\$146.00	\$146.00	Hulog Joseph&Marygrace
645 261 39 00	1.00	SFD	2	1.00	1.00	1.00	\$146.00	\$146.00	Bartolome Jayzen S
645 261 40 00	1.00	SFD	2	1.00	1.00	1.00	\$146.00	\$146.00	Toubia Jamil
645 261 41 00	1.00	SFD	2	1.00	1.00	1.00	\$146.00	\$146.00	Garcia Juan L&Claudia I
645 261 42 00	1.00	SFD	2	1.00	1.00	1.00	\$146.00	\$146.00	Fannin Jeffrey T&Tashena A
645 261 43 00	1.00	SFD	2	1.00	1.00	1.00	\$146.00	\$146.00	Lopez Peter&Irma
645 261 44 00	1.00	SFD	2	1.00	1.00	1.00	\$146.00	\$146.00	Rojas Juan&Blanca A
645 261 45 00	1.00	SFD	2	1.00	1.00	1.00	\$146.00	\$146.00	Aplin Kevin
645 261 46 00	1.00	SFD	2	1.00	1.00	1.00	\$146.00	\$146.00	Mansibang Kristine M F
645 261 47 00	1.00	SFD	2	1.00	1.00	1.00	\$146.00	\$146.00	Obispo John M&Mayflor M
645 261 48 00	1.00	SFD	2	1.00	1.00	1.00	\$146.00	\$146.00	Castro Eduardo&Alicia
645 261 49 00	1.00	SFD	2	1.00	1.00	1.00	\$146.00	\$146.00	Morales Herman P&Teresa E
645 261 50 00	1.00	SFD	2	1.00	1.00	1.00	\$146.00	\$146.00	Pkrichter Revocable Trust 09-27-11
645 261 51 00	1.00	SFD	2	1.00	1.00	1.00	\$146.00	\$146.00	Golston Ellen
645 261 52 00	1.00	SFD	2	1.00	1.00	1.00	\$146.00	\$146.00	Sepulveda Gladys A
645 261 53 00	1.00	SFD	2	1.00	1.00	1.00	\$146.00	\$146.00	Mones Rheden
645 261 54 00	1.00	SFD	2	1.00	1.00	1.00	\$146.00	\$146.00	Galang Family Trust 12-07-17
645 261 55 00	1.00	SFD	2	1.00	1.00	1.00	\$146.00	\$146.00	Partida Esteban O&Ortiz Amber A D D
645 261 56 00	1.00	SFD	2	1.00	1.00	1.00	\$146.00	\$146.00	Jaeger Matthew T
645 261 57 00	1.00	SFD	2	1.00	1.00	1.00	\$146.00	\$146.00	Medina Samantha R
645 261 58 00	1.00	SFD	2	1.00	1.00	1.00	\$146.00	\$146.00	Deleon Deogracias R&Maria Belen B
645 261 59 00	1.00	SFD	2	1.00	1.00	1.00	\$146.00	\$146.00	Meza Fernando L
645 261 60 00	1.00	SFD	2	1.00	1.00	1.00	\$146.00	\$146.00	Garcia Jesse A
645 261 61 00	1.00	SFD	2	1.00	1.00	1.00	\$146.00	\$146.00	Martinez Manuel J

EXHIBIT C - Assessment Roll (Fiscal Year 2019)

Robinhood Ridge Maintenance Assessment District

Parcel Number	Acres/ Units ⁽¹⁾	Land Use ⁽²⁾	NW Otay Zone	Apportionment Factors		Total EBUs	Unit Cost (\$/EBU)	FY 2019 ⁽⁴⁾ Assessment	Owner Name
				Land Use ⁽²⁾	Benefit ⁽³⁾				
645 261 62 00	1.00	SFD	2	1.00	1.00	1.00	\$146.00	\$146.00	Arias Marco A
645 261 63 00	1.00	SFD	2	1.00	1.00	1.00	\$146.00	\$146.00	Blue Anthony&Monique
645 261 64 00	1.00	SFD	2	1.00	1.00	1.00	\$146.00	\$146.00	Pedroza Roberto&Desiree
645 261 65 00	1.00	SFD	2	1.00	1.00	1.00	\$146.00	\$146.00	Dang Vinh Q&Elizabeth Revocable 2009 Trust
645 261 66 00	1.00	SFD	2	1.00	1.00	1.00	\$146.00	\$146.00	Aguilar Adrian A&Avila Claudia
645 261 67 00	1.00	SFD	2	1.00	1.00	1.00	\$146.00	\$146.00	Trevino Jaime A&Diana L
645 261 68 00	1.00	SFD	2	1.00	1.00	1.00	\$146.00	\$146.00	Guzman Marco A&Reyna J
645 261 69 00	1.00	SFD	2	1.00	1.00	1.00	\$146.00	\$146.00	Wallace Brandon&Jessica L
645 261 75 00	1.00	SFD	2	1.00	1.00	1.00	\$146.00	\$146.00	Montenegro Anthony C&Kimberly A
645 261 78 00	1.00	SFD	2	1.00	1.00	1.00	\$146.00	\$146.00	Holden Traci Y Living Trust 09-20-06

TOTAL	-	-	-	-	-	574.57	-	\$83,888	
--------------	---	---	---	---	---	---------------	---	-----------------	--

⁽¹⁾ Applicable units (acres or dwelling units) dependent upon Land Use.

⁽²⁾ Refer to Assessment Engineer's Report for description of Land Use and applicable Land Use Factor.

⁽³⁾ Refer to Assessment Engineer's Report for applicable Benefit Factor.

⁽⁴⁾ FY 2019 is the City's Fiscal Year 2019, which begins July 1, 2018 and ends June 30, 2019.