

MATERIAL LIST

- 1 CONCRETE TEST BOX, SDW128, FOR TEST BOX PLACEMENT SEE WS-03
- 2 4 - #8 AWG HMWPE WIRE WITH 18" OF SLACK WIRE AT PIPE CONNECTION AND 24" SLACK WIRE INSIDE TEST BOX
- 3 EXOTHERMIC WELD OR PIN BRAZE WIRE TO PIPE, PER SDW-125
- 4 WIRE TRENCH AND STREET REPAIRS PER SDW-126 AND SDG117 OR SDG-118
- 5 6" WIDE, RED PLASTIC WARNING TAPE
- 6 SCH 40 PVC ELECTRICAL CONDUIT
- 7 METALLIC PIPE
- 8 ATTACH TO NEAREST PIPE JOINT WHEN POSSIBLE
- 9 GRADE XX PHENOLIC TERMINAL BOARD, 5" x 5" x 1/4"
- 10 WIRE LABEL PER SDW-131
- 11 STAINLESS STEEL BINDING POST TINKER & RASOR #164-060, PROMARK #PM-TS3-LUGS, OR EQUAL
- 12 1/4" -20 STAINLESS STEEL NYLON INSERT LOCK NUT
- 13 1/4" STAINLESS STEEL FLAT WASHER

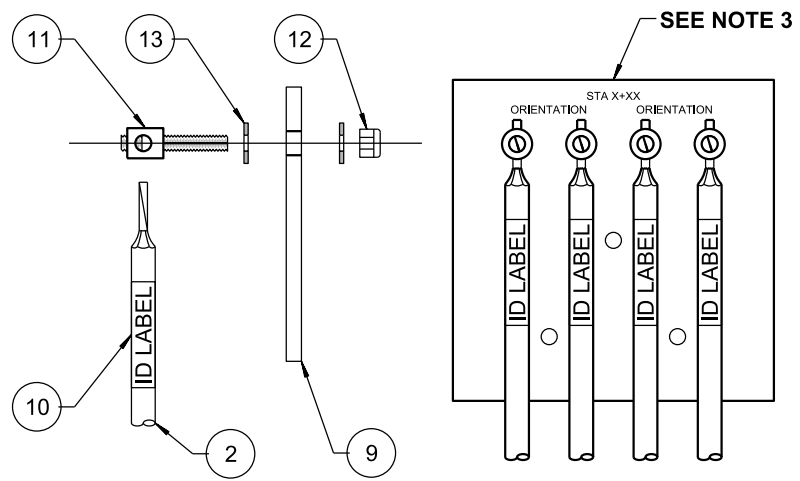
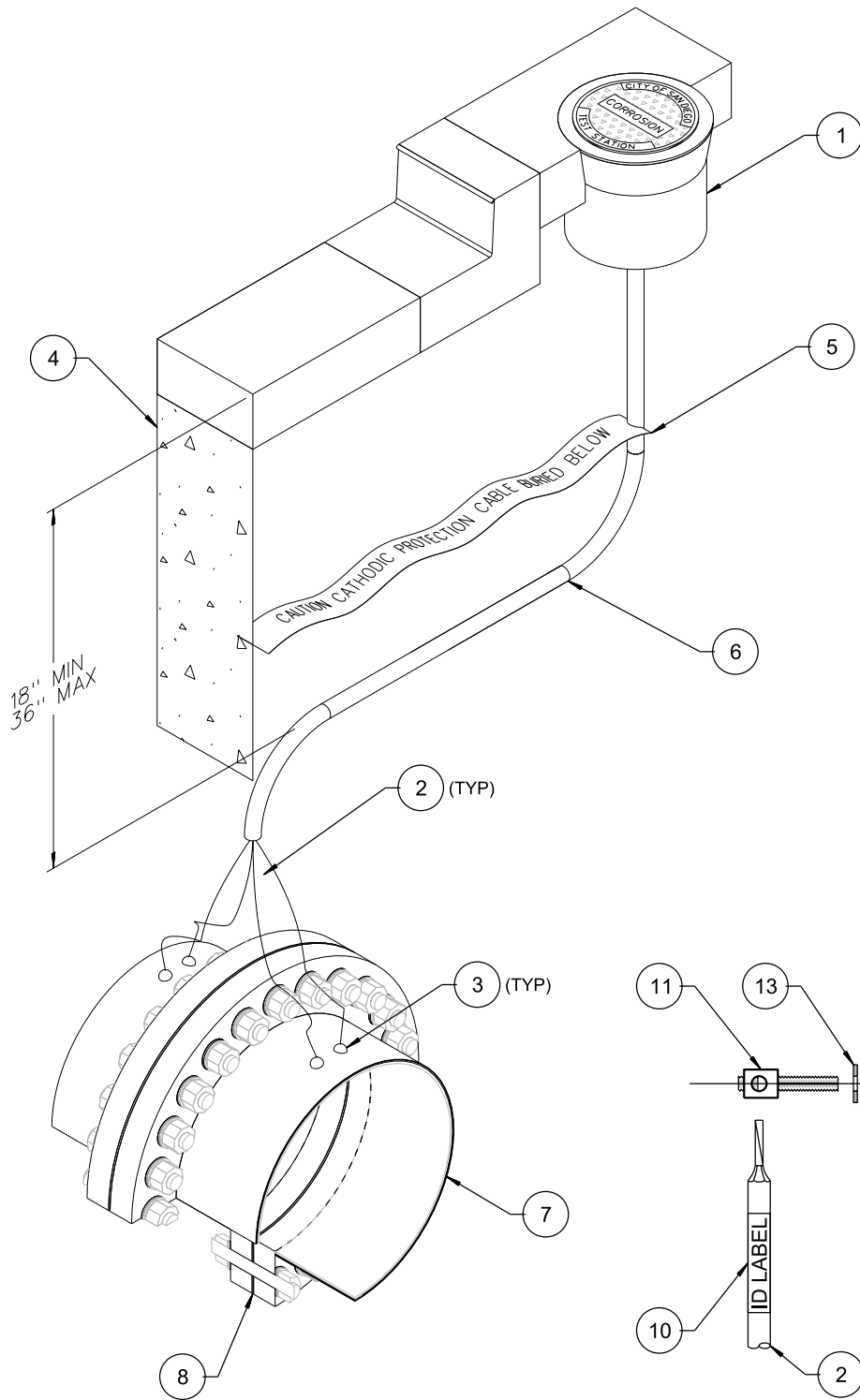

NOTES:

- 1. FOR LOCATION OF TEST STATION, USE REGIONAL STD DWG WS-03. EXACT LOCATION SHALL BE APPROVED BY CORROSION ENGINEER. IF INSTALLED BEHIND THE SIDEWALK OR IN LANDSCAPED AREA, PLACE TEST BOX IN A STEEL REINFORCED CONCRETE COLLAR 24" X 24" X 6" OR 24" DIA X 6".
- 2. FOR UNDEVELOPED AREAS USE SDW-127.
- 3. REPLACE "STA X+XX" WITH APPROPRIATE PIPELINE STATIONING.

SHEET 1 OF 2

REVISION	BY	APPROVED	DATE	CITY OF SAN DIEGO - STANDARD DRAWING	RECOMMENDED BY THE CITY OF SAN DIEGO STANDARDS COMMITTEE
ORIGINAL		A. OSKOUJ	12/03		
UPDATED	KA	J. NAGELVOORT	01/12		
UPDATED	HM	J. NAGELVOORT	02/15		
REDRAFTED	CD	J. NAGELVOORT	09/18		
UPDATED	EF	J. NAGELVOORT	10/19		
				DRAWING NUMBER	SDW-130

MATERIAL LIST

- 1 CONCRETE TEST BOX, SDW128, FOR TEST BOX PLACEMENT SEE **WS-03**
- 2 4 - #8 AWG HMWPE WIRE WITH 18" OF SLACK WIRE AT PIPE CONNECTION AND 24" SLACK WIRE INSIDE TEST BOX
- 3 EXOTHERMIC WELD OR PIN BRAZE WIRE TO PIPE, **PER SDW-125**
- 4 WIRE TRENCH AND STREET REPAIRS **PER SDW-126 AND SDG117 OR SDG-118**
- 5 6" WIDE, RED PLASTIC WARNING TAPE
- 6 SCH 40 PVC ELECTRICAL CONDUIT
- 7 METALLIC PIPE
- 8 ATTACH TO NEAREST PIPE JOINT WHEN POSSIBLE
- 9 GRADE XX PHENOLIC TERMINAL BOARD, 5" x 5" x 1/4"
- 10 WIRE LABEL **PER SDW-131**
- 11 STAINLESS STEEL BINDING POST TINKER & RASOR #164-060, PROMARK #PM-TS3-LUGS, OR EQUAL
- 12 1/4" -20 STAINLESS STEEL NYLON INSERT LOCK NUT
- 13 1/4" STAINLESS STEEL FLAT WASHER

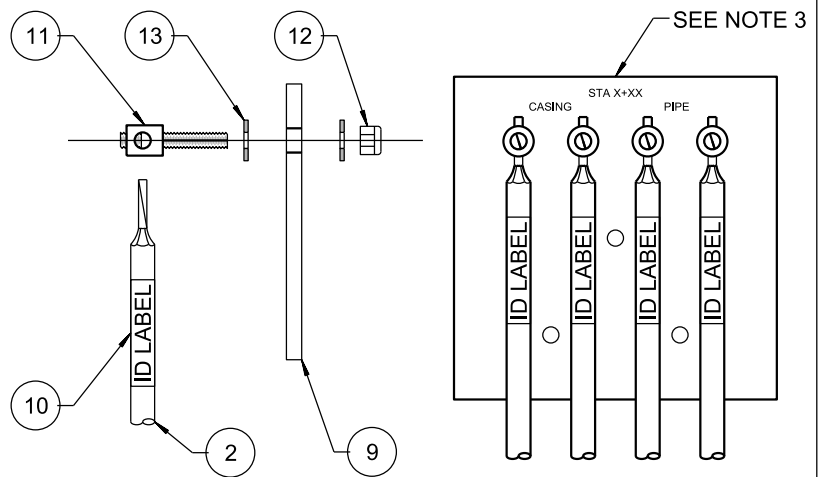
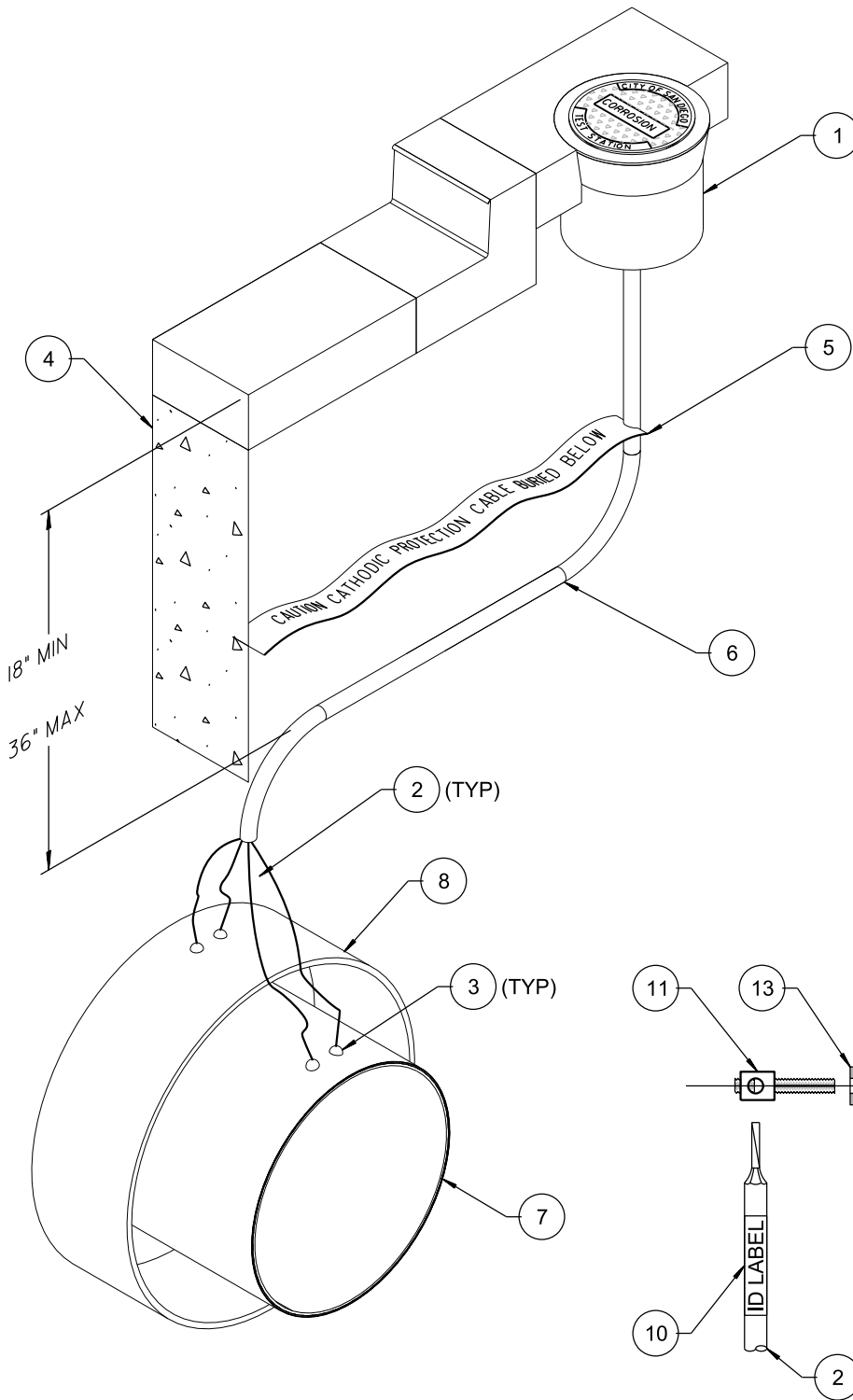

NOTES:

- 1. FOR LOCATION OF TEST STATION, USE REGIONAL STD DWG WS-03. EXACT LOCATION SHALL BE APPROVED BY CORROSION ENGINEER. IF INSTALLED BEHIND THE SIDEWALK OR IN LANDSCAPED AREA, PLACE TEST BOX IN A STEEL REINFORCED CONCRETE COLLAR 24" X 24" X 6" OR 24" DIA X 6".
- 2. FOR UNDEVELOPED AREAS USE **SDW-127**.
- 3. REPLACE "STA X+XX" WITH APPROPRIATE PIPELINE STATIONING.

SHEET 2 OF 2

REVISION	BY	APPROVED	DATE	CITY OF SAN DIEGO - STANDARD DRAWING	RECOMMENDED BY THE CITY OF SAN DIEGO STANDARDS COMMITTEE
ORIGINAL		A. OSKOUI	12/03		
UPDATED	KA	J. NAGELVOORT	01/12		
UPDATED	HM	J. NAGELVOORT	02/15		
REDRAFTED	CD	J. NAGELVOORT	09/18		
UPDATED	EF	J. NAGELVOORT	10/19	SDW-130	